

# The isocheck 23C & 14C systems

CI/SfB (43) (Y) (P2)

August 2008

Rev 2.1

Overlay system for new build, conversion & refurbishment

product data sheet

## PRODUCT DATA

Overall size: Isocheck 23C	2400mm x 600mm x 23mm
Isocheck 14C	1200mm x 600mm x 14mm
Resilient layer thickness	5.5mm
Resilient layer	Isopoli cross linked
Weight: Isocheck 23C	15.38kg/m <sup>2</sup>
Isocheck 14C	7.06kg/m <sup>2</sup>

## PERFORMANCE (on the construction illustrated below top)

Treated floor with:	$D_{nT,w} + C_{tr}$	$L'_{nT,w}$
Isocheck 23C	53.5dB	53dB (rated ★★)
Isocheck 14C	under development towards a further anticipated performance improvement, when compared to Isocheck 23C	

## DESCRIPTION

Isocheck 23C & 14C systems are designed to reduce sound transmission and also reduce impact sound transmission through concrete floors.

Isocheck 23C consists of a 5.5 mm layer of cross-linked Isopoli bonded to 18mm P5 V313 moisture resistant chipboard, whereas Isocheck 14C consists of a 5.5 mm layer of cross-linked Isopoli bonded to 9mm moisture resistant medium density fibreboard. When installed as part of a complete party floor construction either system enables a concrete floor to meet the sound transmission standards of ADE 2003 (amended 2004).

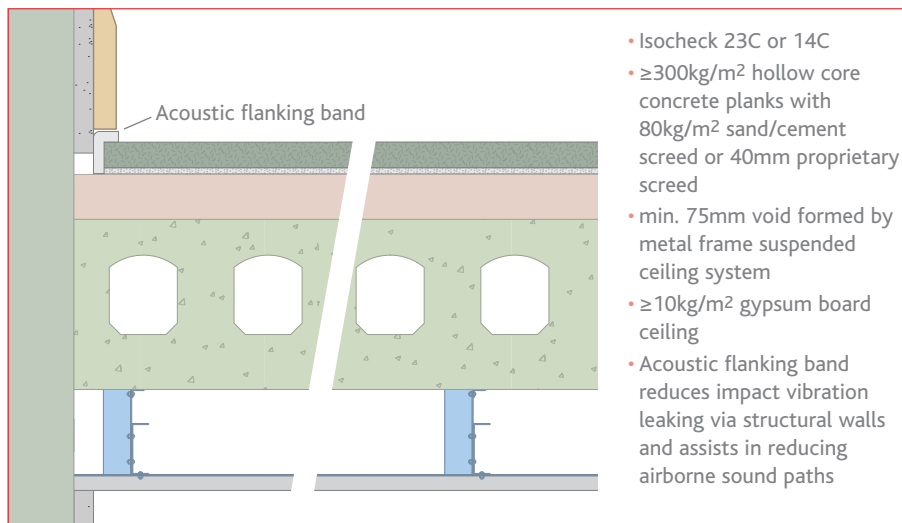

## SPECIFICATION

The acoustic floor shall be:

- **Isocheck 23C or 14C**, manufactured by Isomass Ltd. St Johns Innovation Centre, Cowley Road, Cambridge, CB4 0WS and installed in accordance with manufacturer's instructions / recommendations.

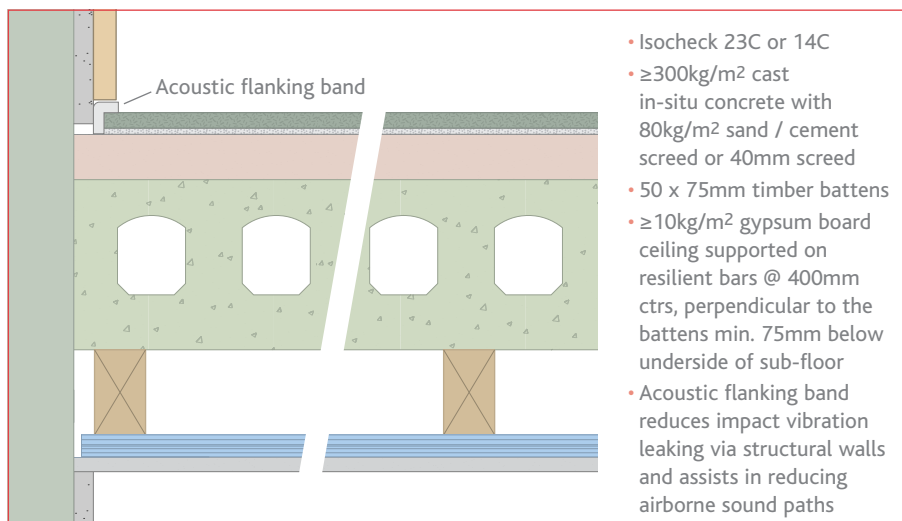

## INSTALLATION

- Lay Isocheck Deck 23C or 14C over level screed, in stretcher bond pattern, applying Isocheck adhesive to all tongued and grooved panel joints.
- Fix Isocheck angled Acoustic Flanking Band on the edges of the Isocheck boards just before they are pushed against the perimeter walls to isolate the board from the wall.
- Install skirting and trim off excess Flanking Band.
- Full installation instructions are available and must be used in conjunction when laying this floating floor system.

For advice on treatment of services and penetrations, consult our brochure or visit our website:

[www.isomass.co.uk](http://www.isomass.co.uk)

Every effort has been taken in the preparation of this sheet to ensure the accuracy of representations contained herein. Recommendations as to the use of materials, construction details and methods of installation are given in good faith and relate to typical situations. However, every site has different characteristics and reliance should not be placed upon the foregoing recommendations. Advice can be given as to specific applications.

## TECHNICAL ENQUIRIES

Tel: 0845 838 33 99

Fax: 0845 838 33 89

Email: [info@isomass.co.uk](mailto:info@isomass.co.uk)