

The isocheck 37T system

CI/SfB
_____ (43) _____ (Y) _____ (P2)

August 2008

Rev 3.0

Direct to joists for conversion & refurbishment (using a direct fixed ceiling)

product data sheet

PRODUCT DATA

Overall size	2400mm x 600mm x 37mm
Resilient layer thickness	15mm
Resilient layer	Isolate FR: class O and thermally rated
Weight	19.05kg/m ²

PERFORMANCE (on the construction illustrated below)

Treated floor with: Isocheck 37T with boarded ceiling	$D_{nT,w} + C_{tr}$ 45dB	$L'_{nT,w}$ 59dB
---	-----------------------------	---------------------

DESCRIPTION

Isocheck 37T system is designed to reduce sound transmission and thermally enhance traditional joisted timber floors and concrete floors.

Isocheck 37T consists of a unique 15mm, fire and thermally rated 'Isolate FR' resilient layer, bonded to 22mm P5 V313 moisture resistant chipboard.

When installed as part of a complete party floor, this system enables a traditional timber joisted floor to meet the sound insulation standards of ADE 2003 (amended 2004).

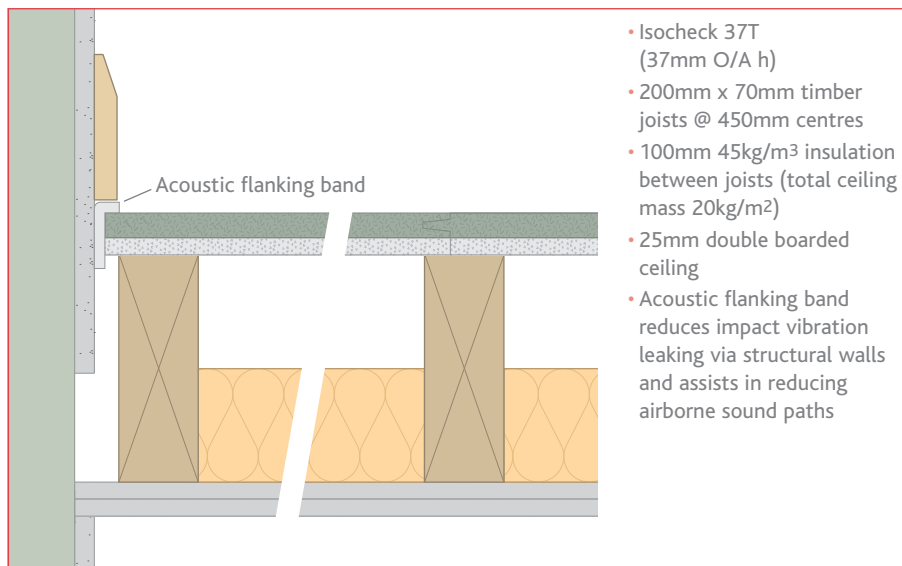

SPECIFICATION

The acoustic floor shall be:

- **Isocheck 37T**, manufactured by Isomass Ltd. St Johns Innovation Centre, Cowley Road, Cambridge, CB4 0WS and installed in accordance with manufacturer's instructions / recommendations.

INSTALLATION

- Lay Isocheck 37T directly to the timber joists, in stretcher bond pattern, applying Isocheck adhesive to all tongued and grooved panel joints.
- Fix Isocheck angled Acoustic Flanking Band on the edges of the Isocheck boards just before they are pushed against the perimeter walls to isolate the board from the wall.
- Install skirting and trim off excess Flanking Band.
- Full installation instructions are available and must be used in conjunction when laying this floating floor system.

For advice on treatment of services and penetrations, consult our brochure or visit our website:

www.isomass.co.uk

Every effort has been taken in the preparation of this sheet to ensure the accuracy of representations contained herein. Recommendations as to the use of materials, construction details and methods of installation are given in good faith and relate to typical situations. However, every site has different characteristics and reliance should not be placed upon the foregoing recommendations. Advice can be given as to specific applications.

TECHNICAL ENQUIRIES

Tel: **0845 838 33 99**

Fax: **0845 838 33 89**

Email: info@isomass.co.uk