

AWV39

Acoustic Wall Ventilator

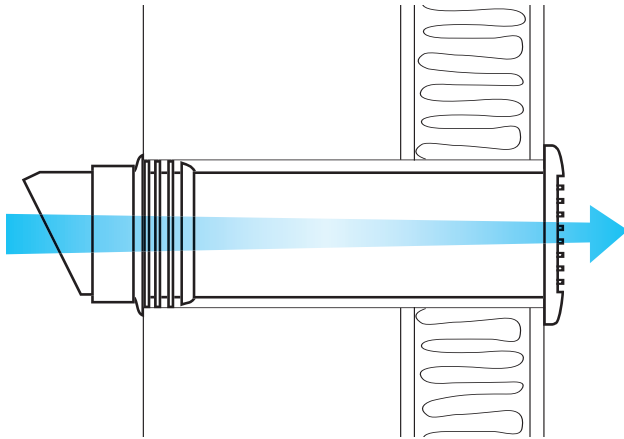

Provides trickle ventilation in line with current Building Regulations

Natural inlet ventilator

Excellent acoustic attenuation

Designed for use in refurbishment applications

Suitable for wall thicknesses 255 – 370mm

Greenwood's acoustic wall ventilator provides 5000mm² free area and is suitable for installation in refurbishment applications. Once installed the vent offers effective protection against noise, providing acoustic attenuation performance to D_{n,e} w 39dB, making it suitable for use near to busy roads, airports and industrial sites.

Suitable for internal wall constructions of between 255 and 370mm, the product is simply installed using a core drill of 117mm cut through the wall. Once pushed through the wall, the ready fixed seal automatically provides weather protection between the sleeve and external grille.

The AWW39 is supplied as a complete unit, comprising pvc sleeve with sound absorbing material, internal flush fit grille available in white and external hooded grille available in white and brown.

Complete installation can be achieved from inside the building therefore negating the use of ladders or scaffolding and saving time on site.

Dimensions (mm)

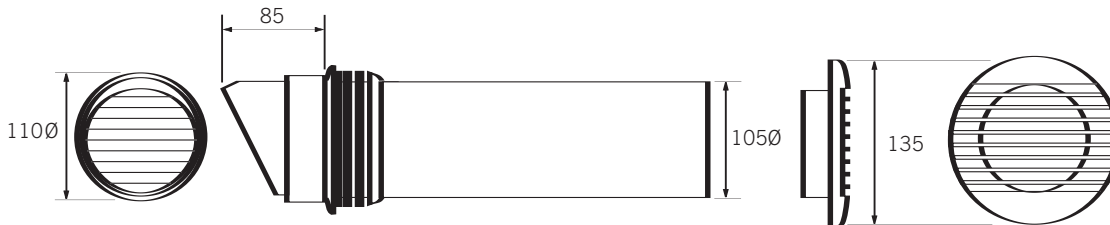

Models and Physical Specification

Model	Free Area (mm ²)	Dimensions (mm)	Standard core drill (mm)	Colour
AWV39	5000	105 Ø x 395 long	117	W (internal & external grilles) B (external grille only)

Colour: White (W), Brown (B).

AWV39

Acoustic Wall Ventilator

Acoustic Performance

BS EN ISO 717-1: 1997 Airborne Sound Insulation (dB)

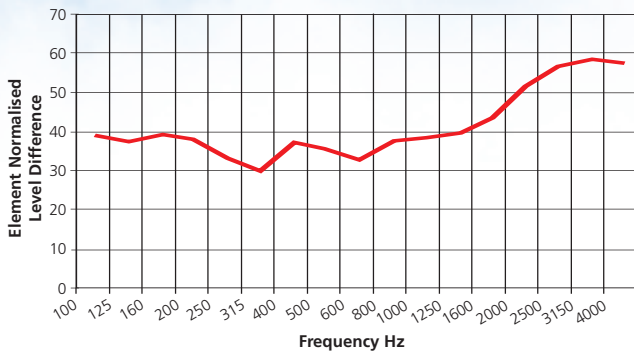

Dn,e,w (C;Ctr) = 39(0;-2) dB

Dn,e,w (C) = 39dB

Dn,e,w (Ctr) = 37dB

Dn,e,w: Average weighted performance across frequency range

C: Pink Noise

Ctr: Road Noise

Full specification detail and test reports are available on request.

How to order

Please state:

1 Model – AWV39

2 Colour – W (white)

4 Quantity – 25

AWV39W x 25

To order please contact Greenwood Customer Services on 01903 777130

Maintenance

Greenwood recommends that any dust be simply removed from the internal mechanism without dismantling.

Installation Instructions

1. Using a 117mm core drill, cut a hole through wall.

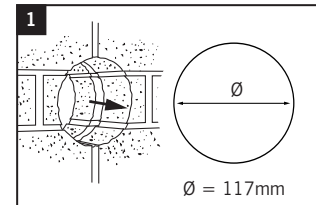

2. Measure wall thickness and cut down plastic sleeve as required.

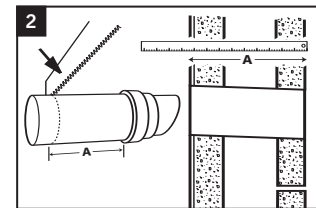

3. Push the sleeve through the wall. The seal will automatically sit between the sleeve and the external grille, providing a watertight fit.

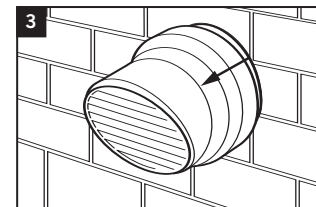

4. Push fit internal grille.

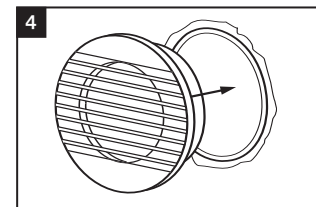

For further information, please contact Greenwood Technical Services on: 0870 900 1880

All information believed to be correct at the time of going to press. All goods are sold according to Greenwood Air Management Ltd's standard condition of sales that are available on request. All dimensions in millimetres unless otherwise shown. Greenwood Air Management reserves the right to change specifications and prices without prior notice. Registered trademarks and patents protect greenwood products.