

# The isocheck Cradle system

CI/SfB (43) (Y) (P2)

August 2008

Rev 2.0

Suspended system for uneven sub-floors in new build or conversion

## product data sheet

### PRODUCT DATA

Overall cradle size	97mm x 97mm x 43.5mm
Height of base plate	11mm
Resilient layer	Isolate C

### PERFORMANCE

Treated floor meets with the descriptive FFT2, typically within Robust Details E-FC-1 or E-FS-1. Two typical alternative constructions are shown above.

### DESCRIPTION

Isocheck Cradle system is designed to reduce sound transmission through concrete floors.

Isocheck Cradle consists of a 10 mm layer of 'Isolate C' bonded to an injection moulded plastic cradle.

When installed as part of a complete party floor construction this system enables a concrete floor to meet the sound transmission standards of ADE 2003 (amended 2004).

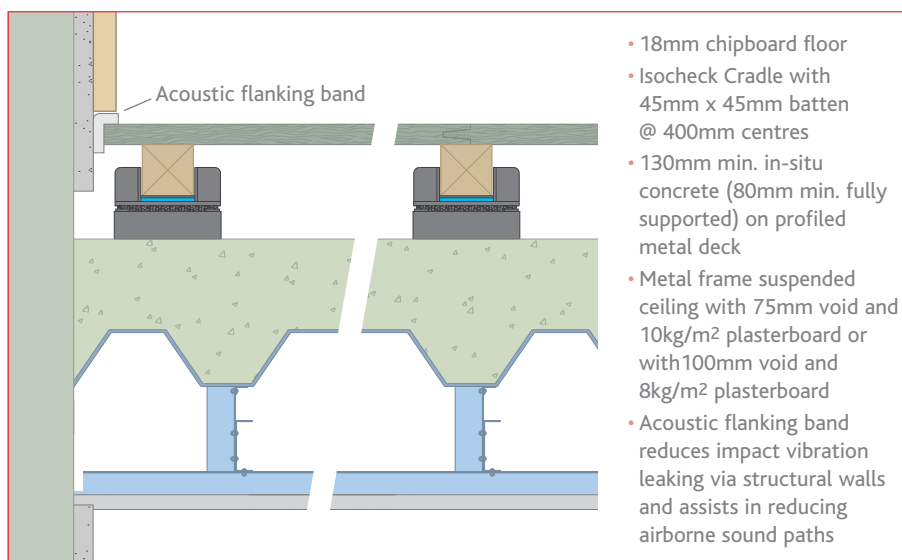
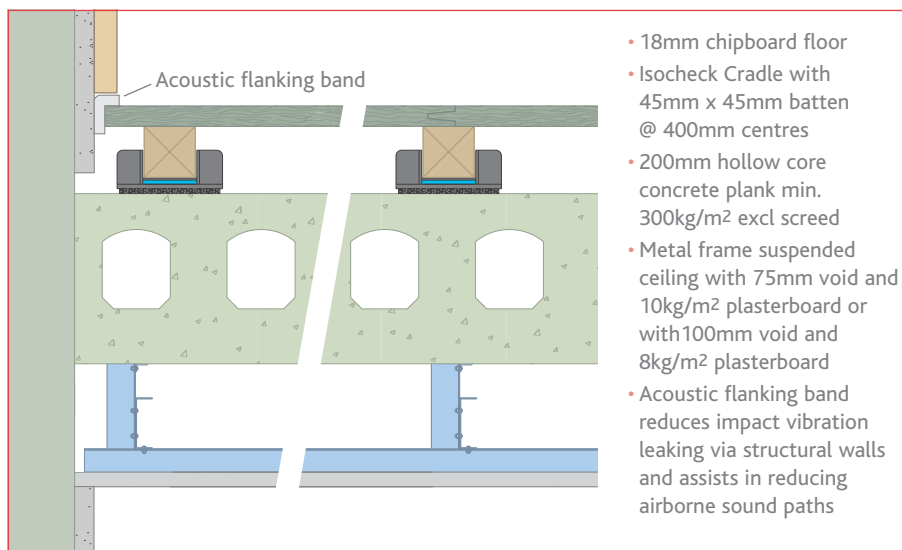

Every effort has been taken in the preparation of this sheet to ensure the accuracy of representations contained herein. Recommendations as to the use of materials, construction details and methods of installation are given in good faith and relate to typical situations. However, every site has different characteristics and reliance should not be placed upon the foregoing recommendations. Advice can be given as to specific applications.

### SPECIFICATION

The acoustic floor shall be:

- **Isocheck Cradle system** (complete with levelling packers), by Isomass Ltd. St Johns Innovation Centre, Cowley Road, Cambridge, CB4 0WS and installed in accordance with manufacturer's instructions / recommendations.

### INSTALLATION

- Lay Isocheck Cradle with 18mm or 22mm chipboard deck in stretcher bond pattern on timber battens (preferably stress graded) with all joints supported, applying adhesive to all tongued and grooved panel joints.
- Fix Isocheck angled Acoustic Flanking Band on the edges of the chipboard just before they are pushed against the perimeter walls to isolate the board from the wall.
- Install skirting and trim off excess Flanking Band.
- Full installation instructions are available and must be used in conjunction when laying this floating floor system.

For advice on treatment of services and penetrations, consult our brochure or visit our website:

[www.isomass.co.uk](http://www.isomass.co.uk)

### TECHNICAL ENQUIRIES

Tel: **0845 838 33 99**

Fax: **0845 838 33 89**

Email: [info@isomass.co.uk](mailto:info@isomass.co.uk)