



DAMP PROOF COURSES

ZEDEX DPC – 03

POLYTHENE DPCS – 15

GAS RESISTANT DPCS – 27



CPT High Performance
Damp Proof System



A breakthrough in High Performance Damp Proofing

- **Zedex CPT High Performance DPC out performs all other high performance flexible DPCs.**
- **Contains no pitch, bitumen or PVC.**
- **Made of modern Co-Polymer Thermoplastic (CPT), it is safe, clean to handle and inert.**
- **Retains it's properties providing long term stability - contains no volatiles to leach out.**
- **Zedex is compatible with complete Visqueen range of damp proofing & gas protection products.**

A Breakthrough in High Performance Damp Proofing

New generation Visqueen Zedex CPT High Performance DPC out performs all other high performance flexible DPCs. It is the new generation of damp proof course, designed to provide a new higher level of security and durability. Made from Co-Polymer Thermoplastic CPT using the latest polymer technology, it possesses the characteristics we believe are necessary in a DPC for it to perform effectively under harsh conditions. It has also been accredited by the British Board of Agrément (94/3059).

As a result of extensive research, development and a rigorous independent testing programme, Visqueen Zedex CPT High Performance DPC has made a number of significant advances.

Zedex is Robust

High tear and puncture resistance characteristics help avoid the failures caused by damage during installation, such as clearing mortar droppings out of the cavity, general manhandling on site and during transport. Independent testing shows the tear strength of Visqueen Zedex CPT High Performance DPC to be many times that of pitch polymer DPCs.

Zedex is Strong and Flexible

Not only does Visqueen Zedex CPT High Performance DPC have almost twice the tensile strength of other pitch polymer damp proof courses, it is also able to withstand twice the amount of stretching. In fact Visqueen Zedex CPT High Performance DPC can be stretched by over 500% from its original dimension - a level of resilience which for example, allows Zedex to accommodate cracking in walls yet maintain the integrity of the waterproof seal.

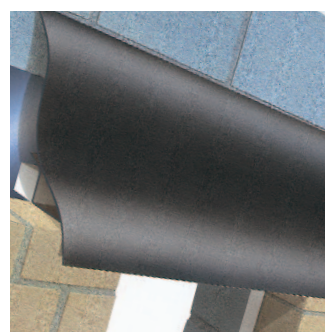

Zedex is Easy to Install Correctly

Visqueen Zedex CPT High Performance DPC has been specifically designed for ease of use on site and to reduce the risk of poor workmanship, which is generally recognised as one of the most common causes of failure in waterproofing systems.

Visqueen Zedex CPT High Performance DPC is easy to join. It is also easy to trim, with its higher resistance to tear and lack of fibres allowing for clean and accurate detailing. Visqueen Zedex CPT High Performance DPC has excellent adhesion to mortar due to a unique surface finish. This assists with the correct positioning of the DPC during building work.

Zedex Masonry Blend

Zedex is now available in a range of colours to match the outer skin. The most popular colours are white and sandstone. Our technical

department will be happy to assist you with product specification.

Zedex is Safe and Clean to Handle

The materials used in Visqueen Zedex CPT High Performance DPC are chemically stable and inert, free of both solvents and aggressive chemicals. Visqueen Zedex CPT High Performance DPC is also clean and safe to use, requiring no special conditions for storage, transport, handling, usage or recycling.

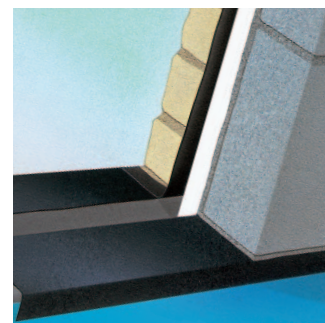



Zedex is Compatible

Visqueen Zedex CPT High Performance DPC avoids the risks of any incompatibility between coal based pitch and oil based bitumen waterproofing materials. It can be used with bituminous liquid DPMs and mastics. Such compatibility is essential in securing a continuous waterproof barrier in a building.

Zedex has High Water Vapour Resistance

The water impermeability of Co-Polymer Thermoplastic material is superior to pitch polymer DPCs. Visqueen Zedex CPT High Performance DPC provides an effective damp proof and water vapour resistant seal being an homogeneous material and free of fibres.

Zedex Maintains Wall Strength Integrity

Visqueen Building Products commissioned Ceram Building Technology to test Visqueen Zedex CPT High Performance DPC under BSI's DD86 Part 1 1983 for flexural bond strength and shear strength. These independent tests show that Visqueen Zedex CPT High Performance DPC has excellent mortar adhesion characteristics. With DPCs being used extensively outside the original ground level applications, understanding the effect of a damp proof course on wall strength becomes increasingly important.

Zedex has High Workability

Visqueen Zedex CPT High Performance DPC has been specifically formulated to remain workable throughout the seasons and prevailing weather conditions.

Zedex Lasts

Visqueen Zedex CPT High Performance DPC is untroubled by environmental conditions over time. Its anti-ageing and dimensional stability properties, as well as its resistance to rot, damage from damp conditions, mildew and UV light are such that Specifiers and Builders can rest assured that Visqueen Zedex CPT High Performance DPC will continue to perform at a high level for the lifetime of the building.

| Visqueen Zedex CPT High Performance DPC | |
|---|---|
| Radon Permeability (k) | 17x10 ⁻¹² m ² /s |
| Radon Transmittance (P) | 22x10 ⁻⁹ m/s |
| Gas (CO2) permeability test in accordance with ISO 2782: 1995 | |
| Permeability Value | 1.58x10 ⁻¹⁶ m ² /sec/Pa |
| Gas Trans. Rate | 66.9 cc/m ² /hr |

REQUIRED COMPONENTS

AVAILABLE AS A DOWNLOAD FROM VISQUEENBUILDING.CO.UK/ZEDEX

| | |
|---|-----|
| VISQUEEN ZEDEX JOINTING SYSTEM | P12 |
| VISQUEEN ZEDEX PRE-FORMED CAVITY TRAY UNITS | P8 |
| VISQUEEN ZEDEX FIXING STRIPS/PINS/PRIMER | P12 |

SPECIFICATION SUPPORT

THE FOLLOWING ITEMS ARE AVAILABLE TO VIEW ONLINE OR TO DOWNLOAD FROM VISQUEENBUILDING.CO.UK/ZEDEX

| | |
|----------------------------------|---|
| TECHNICAL DATASHEETS | ✓ |
| HEALTH & SAFETY DATA | ✓ |
| TYPICAL INSTALLATION CAD DETAILS | ✓ |
| AGREEMENT CERTIFICATE | ✓ |

REGISTER ONLINE FOR ACCESS TO NBS CLAUSES AND FOR INFORMATION ABOUT OUR CPD TRAINING SEMINARS

| | |
|-----------------------|---|
| NBS PLUS CLAUSES | ✓ |
| CPD TRAINING SEMINARS | ✓ |



| Visqueen Zedex CPT High Performance DPC | |
|---|----------------------------|
| Technical Data | |
| Tensile Strength | 20.5 N/mm ² |
| Elongation at Break | 539% |
| Tear Strength | 175.0 N/mm ² |
| Water Vapour Permeability | 0.21 g/m ² /day |
| Accelerated Weathering | |
| Tensile Strength | 18.9 N/mm ² |
| Elongation at Break | 462% |
| Roll Dimensions | |
| Nominal Thickness | 0.8mm |
| Nominal Weight | 0.75 kg/m ² |
| Roll Length | 20m |
| Roll Width | 100mm to 1400mm |



CPT High Performance
Damp Proof System



A New Generation of Performance, Tested and Compared

To prove and verify its high performance status Visqueen Zedex CPT High Performance DPC has undergone a range of independent tests, covering all aspects of its performance.

We have used test methods from Britain, South Africa and the USA to prove that Visqueen Zedex CPT High Performance DPC is the best all round flexible high performance DPC. For example, Tensile Strength and Elongation assess the suitability of damp proof courses in withstanding the stresses and movement of buildings. Such performance is critical: even in a typical house there is, on average, a weight of over 3 tonnes per linear metre in the load bearing wall. A further test for durability is the ability of the material to perform throughout the lifetime of the building.

Visqueen Building Products, in addition to the normal heat ageing tests, has assessed the Tensile Strength and Elongation of Visqueen Zedex CPT High Performance DPC by using an American test method for Accelerated Weathering (ASTM G53).

| Test | Product A | Product B | ZEDEX | Product C | Product D | Best Performance |
|---|---------------------------|-------------------|------------------------------|-----------------|---------------------|------------------|
| | Leading Pitch Polymer DPC | Pitch Polymer DPC | Co-Polymer Thermoplastic DPC | EPDM Rubber DPC | Bitumen Polymer DPC | ZEDEX |
| Tensile Strength BS 2782 : 320A : 1986 N/mm ² | 9.1▼ | 8.6◆ | 20.5▼ | 8.4◆ | 5.5◆ | ZEDEX |
| Elongation at Break BS 2782 : 320A : 1986 % | 200%◆ | 260%◆ | 539%▼ | 140%◆ | 510%◆ | ZEDEX |
| Tear Strength BS 2782 : 360B : 1991 | 27.8▼ | 18.2▼ | 175.0▼ | 13.8▼ | 64.0◆ | ZEDEX |
| Accelerated Weathering Test (ASTM G53 - 1984) Tensile Strength (BS 2782 : 320A : 1986) N/mm ² | 8.5▼ | 10.9▼ | 18.9▼ | 6.9▼ | N/A | ZEDEX |
| Accelerated Weathering Test (ASTM G53 - 1984) % Elongation at Break (BS 2782 : 320A : 1986) | 60%▼ | 70%▼ | 462%▼ | 12%▼ | N/A | ZEDEX |
| Water Vapour Permeability BS 3177 : 1959 (25°C / 75%RH) g/m ² /day | 2.0◆ | 1.4◆ | 0.21* | 0.33◆ | 0.5◆ | ZEDEX |

◆ Manufacturer's published information ▼ University of London * BBA

Tensile Strength, Elongation and Tear Strength tests were conducted along the longitudinal direction of the material.

Comparative Performance

A breakthrough in withstanding building stresses and the construction process.

Damage resistant and better proof against the wet.

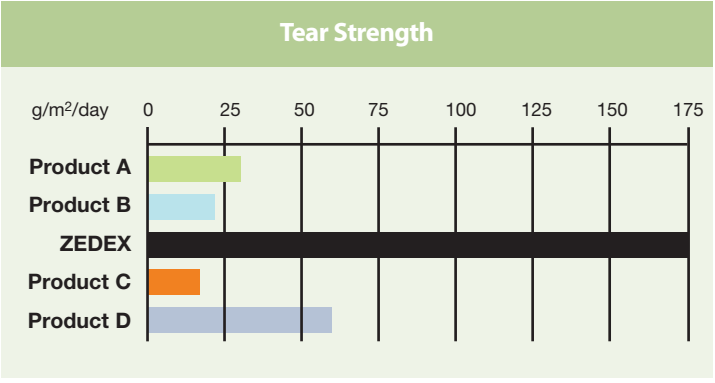
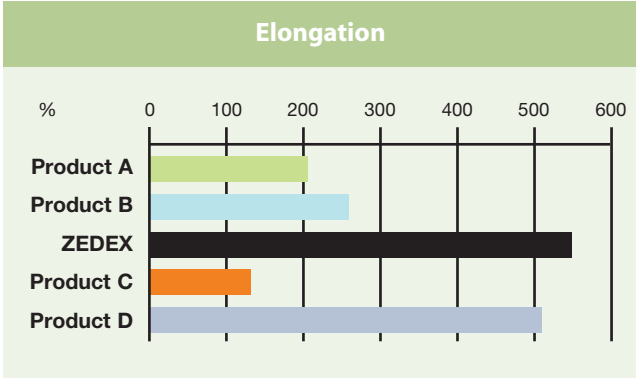
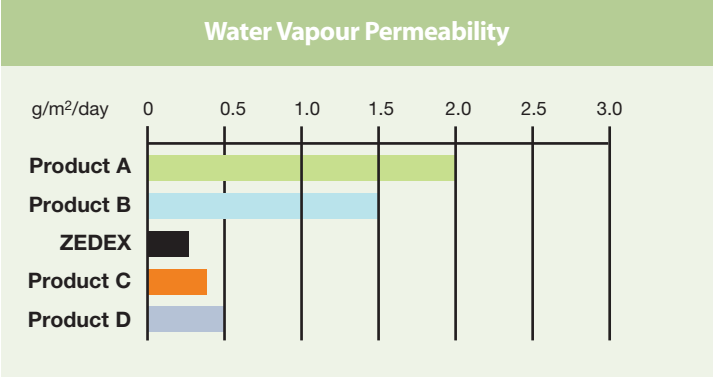
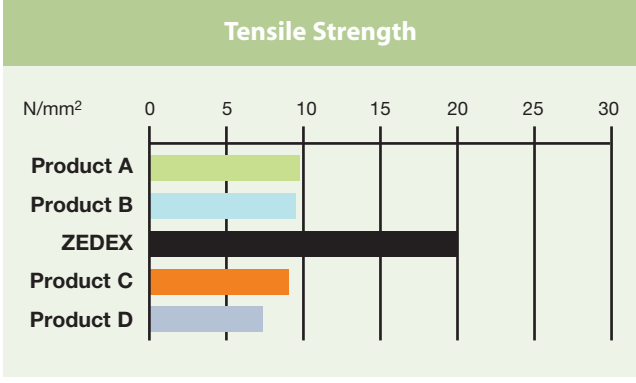

A material that retains its properties.

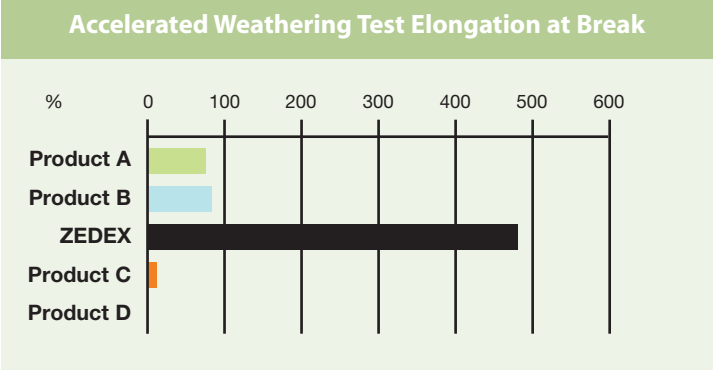
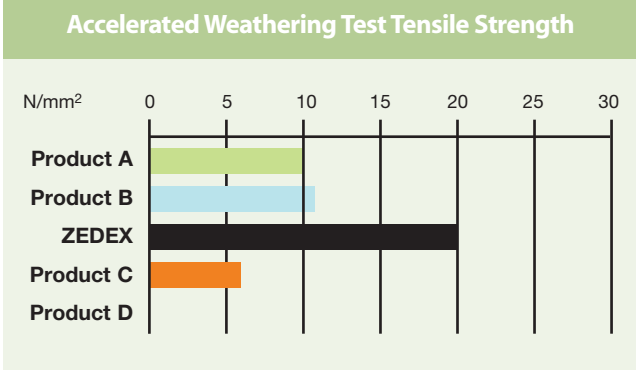



CPT High Performance
Damp Proof System



Installation

Applications

Visqueen Zedex CPT High Performance DPC is suitable for use as a DPC in all types of building construction and can be used in vertical, horizontal, stepped and cavity tray applications. Visqueen Zedex CPT High Performance DPC provides an effective barrier against the passage of moisture and forms an effective waterproof seal.

- Visqueen Zedex CPT High Performance DPC must extend through the full thickness of the wall, including pointing, applied rendering or other facing materials.
- Visqueen Zedex CPT High Performance DPC must be laid on a wet, even bed of mortar, and perforations in adjacent courses of brickwork must be completely filled with mortar.
- Visqueen Zedex CPT High Performance DPC must not be damaged by cavity cleaning after installation.

Further information is available from BBA Certificate (94/3059), available from our web site visqueenbuilding.co.uk

Jointing

All joints in lengths of DPC must be a minimum of 100mm, lapped and bonded using Visqueen Zedex Jointing Tape. All joints between lengths of cavity tray and joints between linear cavity trays and Pre-Formed cavity tray units must be a minimum of 100mm, lapped and bonded using Visqueen Zedex DPC Joint Support.

Further information is available from BBA Certificate (94/3059),

Surface Fixing

Visqueen Zedex DPC Fixing Strip should be used when the construction programme or the design require the DPC to be post or surface fixed to the cavity face of the inner leaf. The surface should first be primed, the DPC then bonded to the inner leaf using Visqueen Zedex Jointing Tape and finally permanently secured using Visqueen Zedex Fixing Strip and Pins at 150mm intervals.

Storage and Handling

The materials used in Visqueen Zedex CPT High Performance DPC are chemically stable and inert and are free of both solvents and aggressive chemicals. Visqueen Zedex CPT High Performance DPC is also clean and safe to use and contains no volatiles to 'leach' out. Due to its robust nature, Visqueen Zedex CPT High Performance DPC requires no special conditions for storage, transport, handling, usage or disposal.

Packaging and Sizes

Visqueen Zedex CPT High Performance DPC is available in all standard widths up to 1400mm. Roll lengths are 20m. Greater and non standard dimensions can be provided on request. Rolls are packed individually.

Availability

Visqueen Zedex CPT High Performance DPC is available from selected Builders Merchants throughout the UK and through Visqueen Building Product's international network. Details of your nearest stockist can be obtained from our Sales Office.

Visqueen Zedex Pre-Formed Cavity Tray Units



- **Made of new advanced CPT damp proofing material.**
- **Use of Visqueen Pre-Formed Cavity Tray Units reduces the time required for installation of DPC at complex corners.**
- **Standard sizes available for domestic cavity widths.**
- **Built in and Surface Fixed Designs.**
- **Special Shapes designed and supplied.**

REQUIRED COMPONENTS

AVAILABLE AS A DOWNLOAD FROM VISQUEENBUILDING.CO.UK/ZEDEX

| | |
|---|-----|
| VISQUEEN ZEDEX JOINTING SYSTEM | P12 |
| VISQUEEN ZEDEX PRE-FORMED CAVITY TRAY UNITS | P8 |
| VISQUEEN ZEDEX FIXING STRIPS/PINS/PRIMER | P12 |

SPECIFICATION SUPPORT

THE FOLLOWING ITEMS ARE AVAILABLE TO VIEW ONLINE OR TO DOWNLOAD FROM VISQUEENBUILDING.CO.UK/ZEDEX

| | |
|----------------------------------|---|
| TECHNICAL DATASHEETS | ✓ |
| HEALTH & SAFETY DATA | ✓ |
| TYPICAL INSTALLATION CAD DETAILS | ✓ |

REGISTER ONLINE FOR ACCESS TO NBS CLAUSES AND FOR INFORMATION ABOUT OUR CPD TRAINING SEMINARS

| | |
|-----------------------|---|
| NBS PLUS CLAUSES | ✓ |
| CPD TRAINING SEMINARS | ✓ |



Description

An integral part of the Visqueen Zedex High Performance Damp Proofing System, the Zedex range of Visqueen Pre-Formed Cavity Tray Units simplify detailing at corners, stop ends and change of levels. They reduce the time required on site to install a DPC in these complex applications. Visqueen Zedex Pre-Formed Cavity Tray Units are manufactured in tough Co-Polymer Thermoplastic material. This material is flexible enough to accommodate normal building tolerances. Visqueen Zedex Pre-Formed Cavity Tray Units are available in brick to block or surface fixed designs.

Zedex Pre-Formed Cavity Tray Units

Visqueen Zedex Pre-Formed Cavity Tray Units are fabricated from Co-Polymer Thermoplastic (CPT). CPT is a new high strength, robust and durable material specially developed by Visqueen Building Products for Damp Proofing. Amongst the advantages that it offers to specifiers are:

Easy to Use

The characteristics of CPT material and the unique design of the units means that Visqueen Zedex Pre-Formed Cavity Trays are more able to accommodate normal building tolerances.

Accomodate Variable Cavity Widths

Visqueen Zedex Pre-Formed Cavity Tray Units can be designed to suit variable cavity width.

Support System Available

A special Joint Support System is available to ensure integrity of joints at DPC laps.

Special Sizes Can be Designed and Manufactured

A comprehensive range of standard units is available from stock. Design and manufacture of special and unusual shapes is available.

The table on the following page is a guide to applications for Visqueen Zedex Pre-Formed Cavity Tray Units. Specials can be designed and manufactured on request.

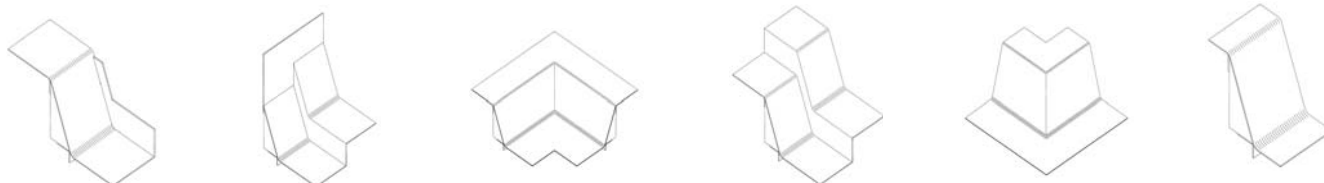



CPT High Performance
Damp Proof System



Guide to Typical Applications - Corners and Change of Levels

| Typical Applications |
|--|
| <p>Stop Ends (Std Detail ZX-10) Stop-End 150 Cavity Rise (LH/RH) Stop-End 225 Cavity Rise (LH/RH)</p> |
| <p>Column Stop Ends (Std Detail ZX-10) Column Stop-End 150 Cavity Rise (LH/RH) Column Stop-End 225 Cavity Rise (LH/RH)</p> |
| <p>Change of Level – Brick to Block (Std Detail ZX-09) 75mm Step on Face BB150 Cavity Rise x 75 Step On Face (LH) BB150 Cavity Rise x 75 Step On Face (RH) BB225 Cavity Rise x 75 Step On Face (LH) BB225 Cavity Rise x 75 Step On Face (RH) 225mm Step on Face BB150 Cavity Rise x 225 Step On Face (LH) BB150 Cavity Rise x 225 Step On Face (RH) BB225 Cavity Rise x 225 Step On Face (LH) BB225 Cavity Rise x 225 Step On Face (RH)</p> |
| <p>Change of Level – Surface Fixed (Std Detail ZX-09) 75mm Step on Face SF150 Cavity Rise x 75 Step On Face (LH) SF150 Cavity Rise x 75 Step On Face (RH) 225mm Step on Face SF150 Cavity Rise x 225 Step On Face (LH) SF150 Cavity Rise x 225 Step On Face (RH)</p> |
| <p>Lintel Stop End (Std Detail ZX-05) Angled Stop-End (LH & RH)</p> |
| <p>Internal Corner – Brick to Block (Std Detail ZX-13) BB Internal Corner 150 Cavity Rise BB Internal Corner 225 Cavity Rise</p> |
| <p>Internal Corner – Surface Fixed (Std Detail ZX-14) SF Internal Corner 150 Cavity Rise</p> |
| <p>External Corner - Brick to Block (Std Detail ZX-13) BB External Corner 150 Cavity Rise BB External Corner 225 Cavity Rise</p> |
| <p>External Corner - Surface Fixed (Std Detail ZX-14) SF External Corner 150 Cavity Rise</p> |
| <p>Joint Support System Joint Support 150 Cavity Rise Joint Support 225 Cavity Rise</p> |

For more typical damp proofing details please visit visqueenbuilding.co.uk/zedex

Expansion Joint

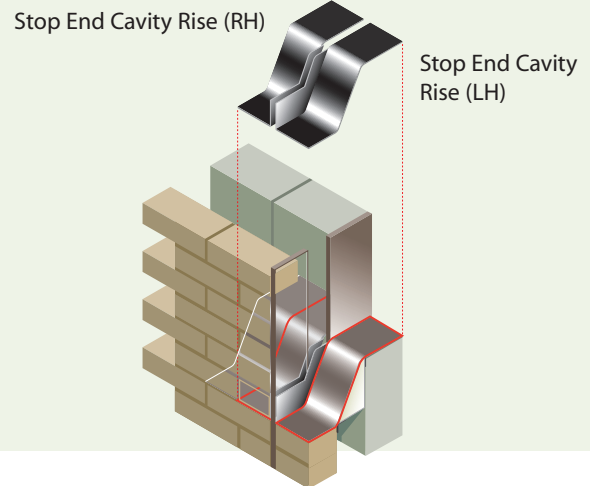

Joint Support

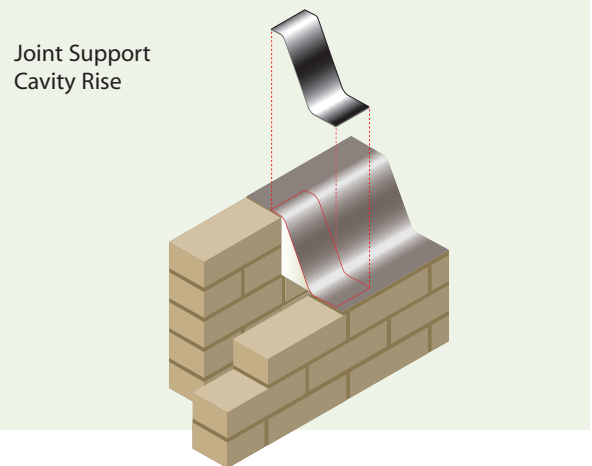

Column in Cavity

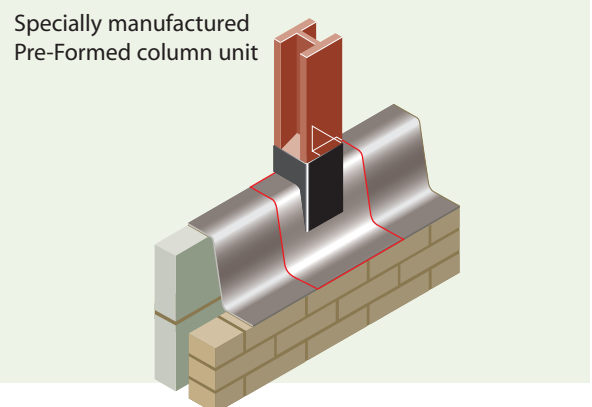

Important
 During installation DPC must overlap preformed unit by 100mm and be fully sealed.

Brick to Brick Applications

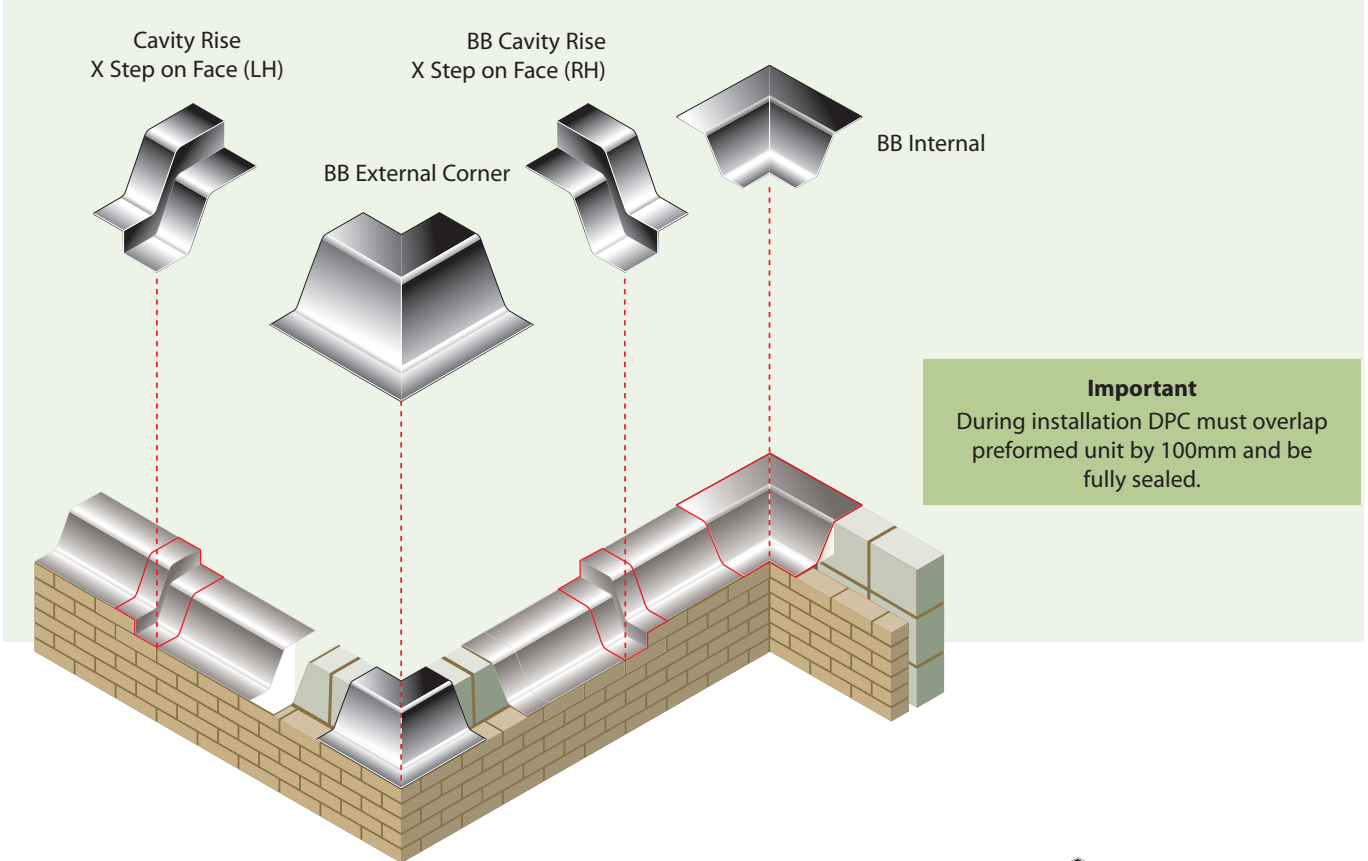

Surfaced Fixed Applications

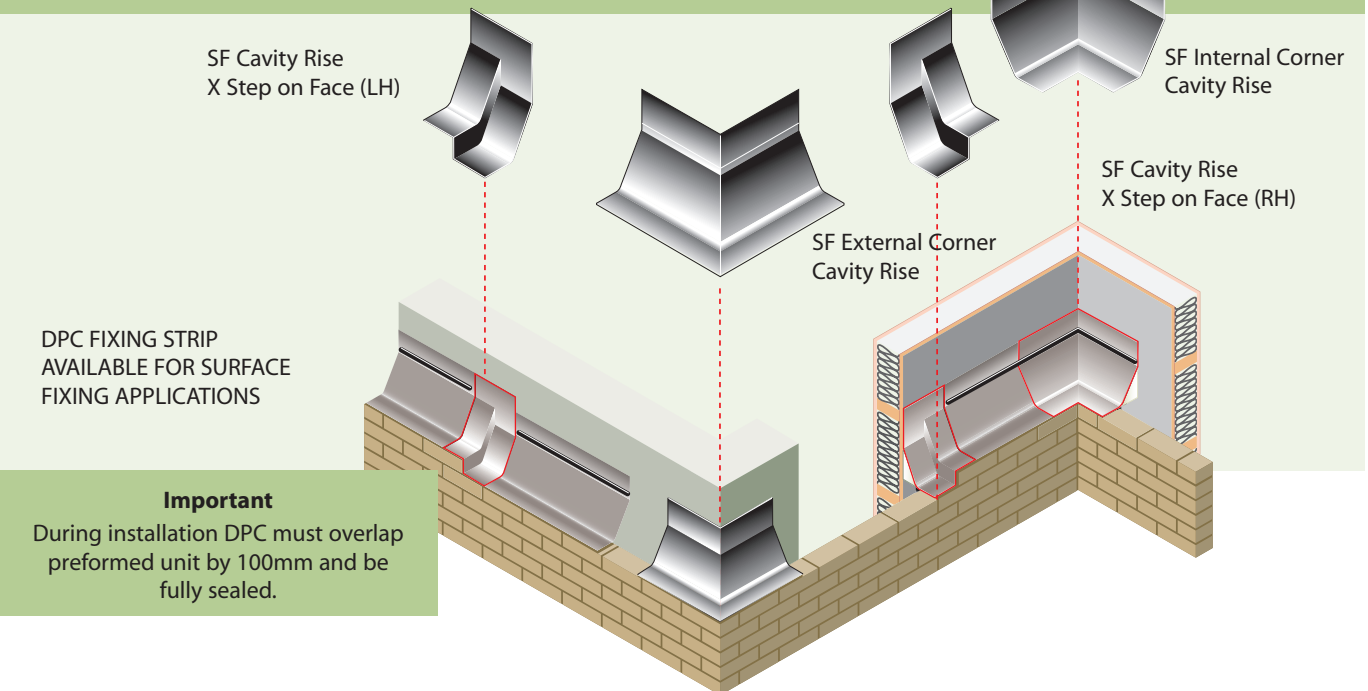

Windows & Doors - Top detail

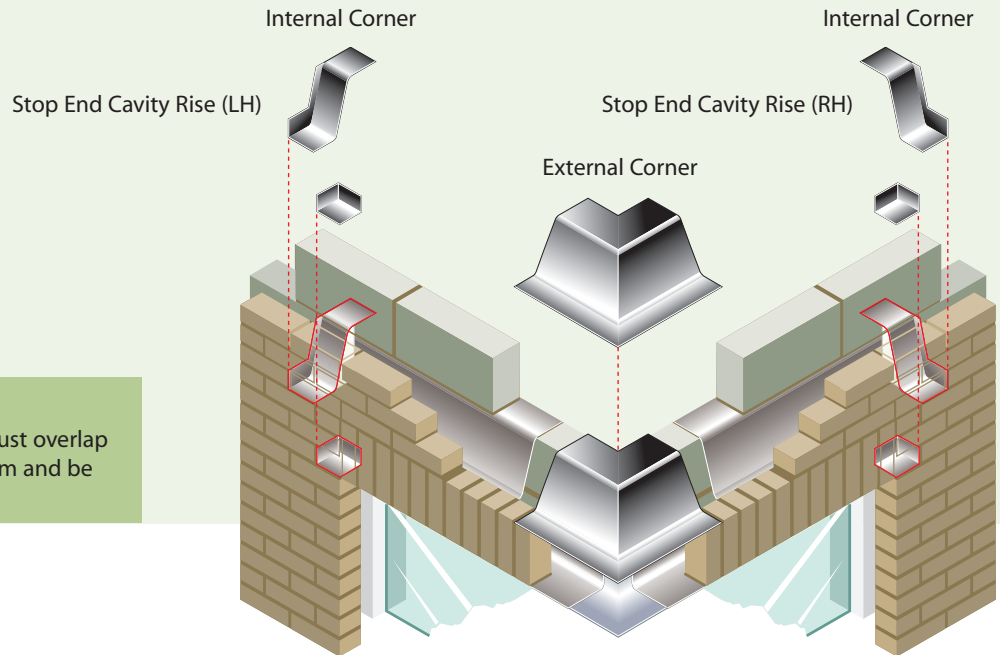

Important
During installation DPC must overlap preformed unit by 100mm and be fully sealed.

Windows & Doors - Bottom detail

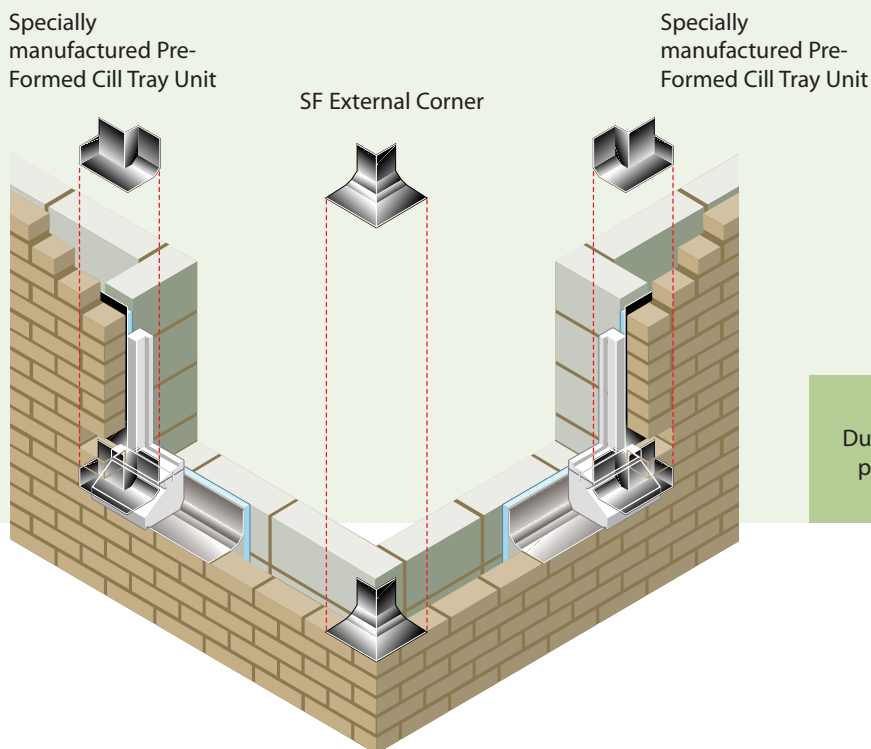

Important
During installation DPC must overlap preformed unit by 100mm and be fully sealed.

Visqueen Zedex CPT High Performance DPC Jointing System



- A comprehensive system for ensuring integrity of Visqueen Zedex CPT High Performance DPC laps and joins.
- Visqueen Zedex DPC Jointing Tape for sealing laps.
- Visqueen Zedex DPC Fixing Strip for applications where DPC cannot be built into the inner leaf.
- Visqueen Zedex Joint Support Units to provide support when sealing joins in cavity trays.

REQUIRED COMPONENTS

AVAILABLE AS A DOWNLOAD FROM VISQUEENBUILDING.CO.UK/ZEDEX

| | |
|---|-----|
| VISQUEEN ZEDEX JOINTING SYSTEM | P12 |
| VISQUEEN ZEDEX PRE-FORMED CAVITY TRAY UNITS | P8 |
| VISQUEEN ZEDEX FIXING STRIPS/PINS/PRIMER | P12 |

SPECIFICATION SUPPORT

THE FOLLOWING ITEMS ARE AVAILABLE TO VIEW ONLINE OR TO DOWNLOAD FROM VISQUEENBUILDING.CO.UK/ZEDEX

| | |
|----------------------------------|---|
| TECHNICAL DATASHEETS | ✓ |
| HEALTH & SAFETY DATA | ✓ |
| TYPICAL INSTALLATION CAD DETAILS | ✓ |

REGISTER ONLINE FOR ACCESS TO NBS CLAUSES AND FOR INFORMATION ABOUT OUR CPD TRAINING SEMINARS

| | |
|-----------------------|---|
| NBS PLUS CLAUSES | ✓ |
| CPD TRAINING SEMINARS | ✓ |



Description

Visqueen Zedex Jointing Tape is a double sided butyl based jointing tape suitable for use in the lapping and sealing of Visqueen Zedex DPC as well as in the surface fixing applications.

Application

Visqueen Zedex DPC Fixing Strip is a 2m linear strip with pre-drilled holes and should be used when the construction programme or the design require the DPC to be surface fixed to the cavity face of the inner leaf. Fixing pins are available for masonry, concrete and insulation substrates.

Installation

All joins in lengths between DPC and Visqueen Pre-Formed Cavity Tray Units must be a minimum of 100mm lapped and bonded using Visqueen Zedex Jointing Tape. The surface should first be primed, using Visqueen Primer the DPC then bonded to the inner leaf using Visqueen Zedex DPC Jointing Tape and finally permanently secured using the fixing strip, mechanically fixed to the inner leaf at 150mm centres.

| Visqueen Zedex Fixing Strip | |
|-------------------------------|-------|
| Technical Data | |
| Dimensions | |
| Length (m) | 2 |
| Width (mm) | 25 |
| Predrilled Hole Diameter (mm) | 8 |
| Colour | Black |

| Visqueen Zedex Jointing Tape | |
|------------------------------|-------|
| Technical Data | |
| Dimensions | |
| Roll Length (m) | 15 |
| Roll Width (mm) | 100 |
| Material | Butyl |
| Colour | Black |

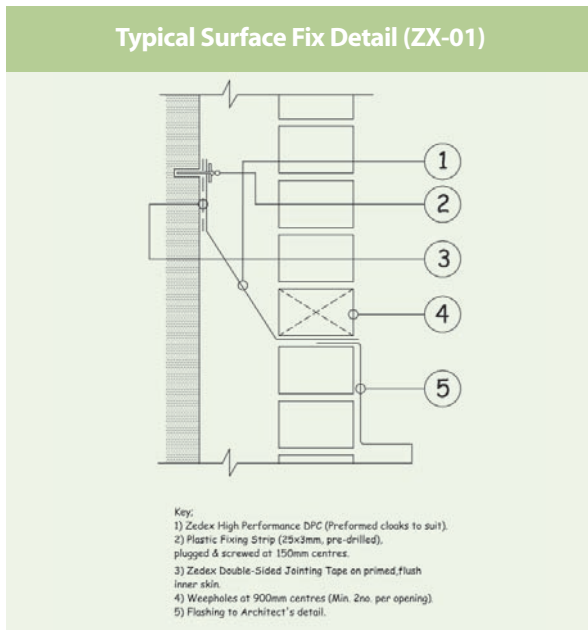



The Next Generation in
Domestic Damp Proofing



The High Performance Damp Proof Course for Domestic Applications

- Visqueen Zedex Housing Grade DPC is based on the same polymer technology as Visqueen Zedex CPT High Performance DPC, the new generation material designed to give higher levels of security and integrity.
- Developed by Visqueen Building Products using the latest polymer technology, Visqueen Zedex Housing Grade DPC offers a superior alternative to polyethylene dpc's.
- Visqueen Zedex Housing Grade DPC is also suitable for use in beam and block systems and has BBA Accreditation.

Visqueen Zedex Housing Grade DPC is Robust

High tear and puncture resistant characteristics help avoid the failures caused by damage during installation. Independent testing shows the tear strength of Visqueen Zedex Housing Grade DPC to many times that of other housing grade DPC's.

Visqueen Zedex Housing Grade DPC is Strong and Flexible

Visqueen Zedex Housing Grade DPC has almost twice the tensile strength of other pitch polymer housing grade damp proof courses.

Visqueen Zedex Housing Grade DPC has High Water Vapour Resistance

The water impermeability of Co-Polymer Thermoplastic material is superior to pitch polymer dpc's.

Visqueen Zedex Housing Grade DPC is Compatible

Visqueen Zedex Housing Grade DPC avoids the risks of incompatibility between coal based pitch and oil based bitumen waterproofing materials. It can be used with bituminous liquid DPM's and mastics.

Visqueen Zedex Housing Grade DPC is Safe and Clean to Handle

The materials used in Visqueen Zedex Housing Grade DPC are chemically stable and inert and are free of both solvents and aggressive chemicals. Visqueen Zedex Housing Grade DPC is also clean and safe to use, requiring no special conditions for storage, transport handling, usage and disposal.

Visqueen Zedex Housing Grade DPC has High Workability

Visqueen Zedex Housing Grade DPC has been specifically formulated to remain workable throughout the seasons and prevailing weather conditions.

Visqueen Zedex Housing Grade DPC is Easy to Install Correctly

Co-Polymer Thermoplastic is now widely recognised for its superior characteristics in terms of ease of joining and its ability to be cleanly and accurately detailed on site.

Applications

Visqueen Zedex Housing Grade DPC is suitable for use as a DPC in domestic and residential construction in vertical, stepped and horizontal applications. For other applications use Visqueen Zedex CPT High Performance DPC. Visqueen Zedex Housing Grade DPC may be used in conjunction with beam and block flooring. Installed in accordance with our instructions, Visqueen Zedex Housing Grade DPC provides an effective barrier against the passage of moisture and forms an effective waterproof seal.

| Visqueen Zedex Housing Grade DPC | |
|----------------------------------|---|
| Technical Data | |
| Tensile Strength: | BS 2782:320A 20.4 N/mm ² |
| Elongation at Break: | BS 2782:320A 515% |
| Tear Strength: | BS 2782 360B 135N/mm ² |
| Water Vapour Permeability: | BS 3177 25OC/75% RH 0.3g/m ² /day |
| Roll Dimensions | |
| Nominal Thickness | 0.6mm |
| Nominal Weight | 0.6kg/m ² |
| Roll Length | 20m |
| Roll Width | 100mm to 1400mm |



Installation

Installation must be in accordance with BS5628-3: 1985, BS8000-3:1989, BS8215:1991, BRE Digest 380 Damp Proof Course and the procedures set out in BBA 94/3059 Detail Sheet 3.

- **Visqueen Zedex Housing Grade DPC must extend through the full thickness of the wall, including pointing, applied rendering or other facing materials.**
- **Visqueen Zedex Housing Grade DPC must be laid on a wet, even bed of mortar, and perforations in adjacent courses of brickwork must be completely filled with mortar.**
- **Visqueen Zedex Housing Grade DPC must not be damaged by cavity cleaning after installation.**
- **All laps in Zedex Housing Grade DPC must be a minimum of 100mm and sealed using Visqueen Zedex Jointing Tape. For further information refer to the BBA Certificate (94/3059).**

Storage and Handling

The materials used in Visqueen Zedex Housing Grade DPC are chemically stable and inert and are free of both solvents and aggressive chemicals. Visqueen Zedex Housing Grade DPC is also clean and safe to use and contains no volatiles to 'leach' out. Due to its robust nature, Visqueen Zedex Housing Grade DPC requires no special conditions for storage, transport, handling, usage and disposal.



REQUIRED COMPONENTS

AVAILABLE AS A DOWNLOAD FROM
VISQUEENBUILDING.CO.UK/ZEDEX

| | |
|---|-----|
| VISQUEEN ZEDEX JOINTING SYSTEM | P12 |
| VISQUEEN ZEDEX PRE-FORMED CAVITY TRAY UNITS | P8 |
| VISQUEEN ZEDEX FIXING STRIPS/PINS/PRIMER | P12 |

SPECIFICATION SUPPORT

THE FOLLOWING ITEMS ARE AVAILABLE TO VIEW ONLINE OR TO DOWNLOAD FROM VISQUEENBUILDING.CO.UK/ZEDEX

| | | |
|--|----------------------------------|---|
| | TECHNICAL DATASHEETS | ✓ |
| | HEALTH & SAFETY DATA | ✓ |
| | TYPICAL INSTALLATION CAD DETAILS | ✓ |
| | AGRÉMENT CERTIFICATE | ✓ |

REGISTER ONLINE FOR ACCESS TO NBS CLAUSES AND FOR INFORMATION ABOUT OUR CPD TRAINING SEMINARS

| | |
|-----------------------|---|
| NBS PLUS CLAUSES | ✓ |
| CPD TRAINING SEMINARS | ✓ |



Visqueen Polyethylene DPC

- **Conforms to the requirements of BS 6515.**
- **Cost effective damp proof course for domestic construction.**
- **Embossed to assist mortar adhesion.**
- **Proven performance over many years.**
- **Manufactured from highest quality reprocessed materials.**
- **Remains flexible - even at low temperatures.**
- **Safe and clean to handle.**
- **Suitable for use in horizontal and vertical applications throughout domestic construction.**

Description

Visqueen Polyethylene DPC is designed to prevent the passage of moisture in brick and block work from external sources. Visqueen Polyethylene DPC is manufactured from high quality reprocessed materials to provide a range of cost effective and durable domestic grade DPCs.

The Visqueen Polyethylene DPC range is suitable for use in vertical and horizontal applications throughout two storey domestic constructions. As with all Visqueen Building Products, Visqueen Polyethylene DPC is produced to stringent performance standards and includes a pronounced emboss to improve mortar adhesion. **(Note: in minimal stress applications Visqueen Zedex CPT High Performance DPC should be used).** Visqueen Polyethylene DPC has good cold flex properties, remaining workable at low temperatures. Visqueen Polyethylene DPC is manufactured to the requirements of BS 6515.

Application

Storage & Handling

Visqueen Polyethylene DPC is classified non-hazardous, and is chemically inert. The product requires no special storage conditions, although measures should be made to keep it clean and dry.

Installation

Installation should be in accordance with Code of Practice CP102:1973 as amended. Normal good practice and damp proof course detailing should be followed as described in BS 5628: part III. Work may be carried out in all weathers normal to the construction of walls.

Jointing

All laps and joints in discontinuous lengths of DPC should be fully lapped by at least 100mm and fully sealed using Visqueen Zedex Jointing Tape.

| Visqueen Polyethylene DPC | |
|-------------------------------|--|
| Technical Data | |
| Tensile strength BS2782(320A) | Long: 20.3Nmm ² Trans: 11.2Nmm ² |
| Elongation BS2782(320A) | Long: 301% Trans: 274% |
| Tear Strength MOAT 27:5:4.1 | Long: 169N Trans: 145N |
| Water Vapour Permeability | 0.28gm ² /day |
| Dimensions | |
| Length | 30m |
| Available Widths | 100mm - 1200mm |

Visqueen Polyethylene DPC Jointing System



- A comprehensive system for ensuring integrity of Visqueen Polythene DPC laps and joins.
- Visqueen Zedex DPC Jointing Tape for sealing laps.
- Visqueen Zedex DPC Fixing Strip for applications where DPC cannot be built into the inner leaf.
- Visqueen Zedex Joint Support Units to provide support when sealing joins in cavity trays.

REQUIRED COMPONENTS

AVAILABLE AS A DOWNLOAD FROM VISQUEENBUILDING.CO.UK/ZEDEX

| | |
|---|-----|
| VISQUEEN ZEDEX JOINTING SYSTEM | P12 |
| VISQUEEN ZEDEX PRE-FORMED CAVITY TRAY UNITS | P8 |
| VISQUEEN ZEDEX FIXING STRIPS/PINS/PRIMER | P12 |

SPECIFICATION SUPPORT

THE FOLLOWING ITEMS ARE AVAILABLE TO VIEW ONLINE OR TO DOWNLOAD FROM VISQUEENBUILDING.CO.UK/ZEDEX

| | |
|----------------------------------|---|
| TECHNICAL DATASHEETS | ✓ |
| HEALTH & SAFETY DATA | ✓ |
| TYPICAL INSTALLATION CAD DETAILS | ✓ |

REGISTER ONLINE FOR ACCESS TO NBS CLAUSES AND FOR INFORMATION ABOUT OUR CPD TRAINING SEMINARS

| | |
|-----------------------|---|
| NBS PLUS CLAUSES | ✓ |
| CPD TRAINING SEMINARS | ✓ |



Description

Visqueen Zedex Jointing Tape is a double sided butyl based jointing tape suitable for use in the lapping and sealing of Visqueen Zedex DPC as well as in the surface fixing applications.

Application

Visqueen Zedex DPC Fixing Strip is a 2m linear strip with pre-drilled holes and should be used when the construction programme or the design require the DPC to be surface fixed to the cavity face of the inner leaf. Fixing pins are available for masonry, concrete and insulation substrates.

Installation

All joins in lengths between DPC and Visqueen Pre-Formed Cavity Tray Units must be a minimum of 100mm lapped and bonded using Visqueen Zedex Jointing Tape. The surface should first be primed, using Visqueen Primer the DPC then bonded to the inner leaf using Visqueen Zedex DPC Jointing Tape and finally permanently secured using the fixing strip, mechanically fixed to the inner leaf at 150mm centres.

| Visqueen Zedex Fixing Strip | |
|-----------------------------|-------|
| Technical Data | |
| Dimensions | |
| Length (m) | 2 |
| Width (mm) | 25 |
| Centre Holes (mm) | 25 |
| Colour | Black |

| Visqueen Zedex Jointing Tape | |
|------------------------------|-------|
| Technical Data | |
| Dimensions | |
| Roll Length (m) | 15 |
| Roll Width (mm) | 100 |
| Material | Butyl |
| Colour | Black |