

# The isocheck Impact Mat 100 & 200 systems

Impact improvement system for new build & conversion

CI/SfB  
\_\_\_\_\_ (43) \_\_\_\_\_ (Y) \_\_\_\_\_ (P2)

August 2008

Rev 3.0

## product data sheet

### PRODUCT DATA

Overall size	Mat 100 Mat 200	1.37m x 7.3m long 1.00m x 6.0m long
Resilient layer	Mat 100 Mat 200	5.5mm Isolate M 9.0mm Isolate M
Weight	Mat 100 Mat 200	2.2kg/m <sup>2</sup> 4.2kg/m <sup>2</sup>

### PERFORMANCE

Laboratory performance of isocheck Impact Mat 100 & 200 achieved **25dB** & **30dB**  $\Delta L_w$  respectively. When installed beneath a timber floor but on top of a timber sub-floor it improved the impact result  $L'_{nT,w}$  by **4dB** to **6dB** depending on the structural sub floor.

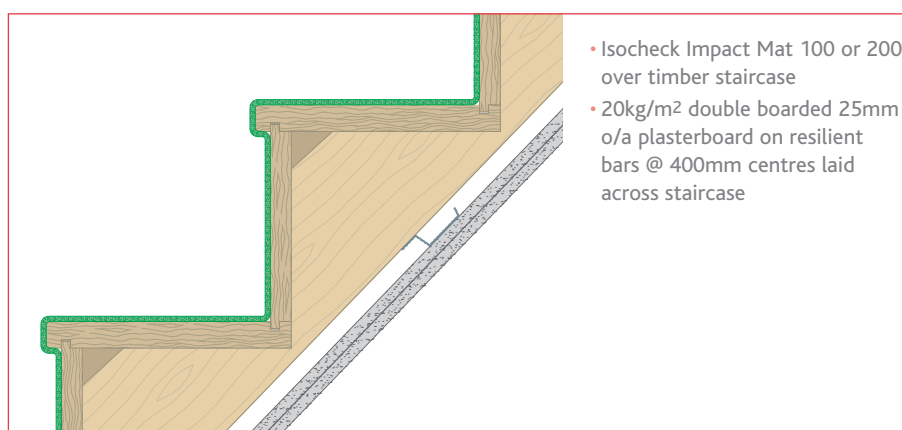
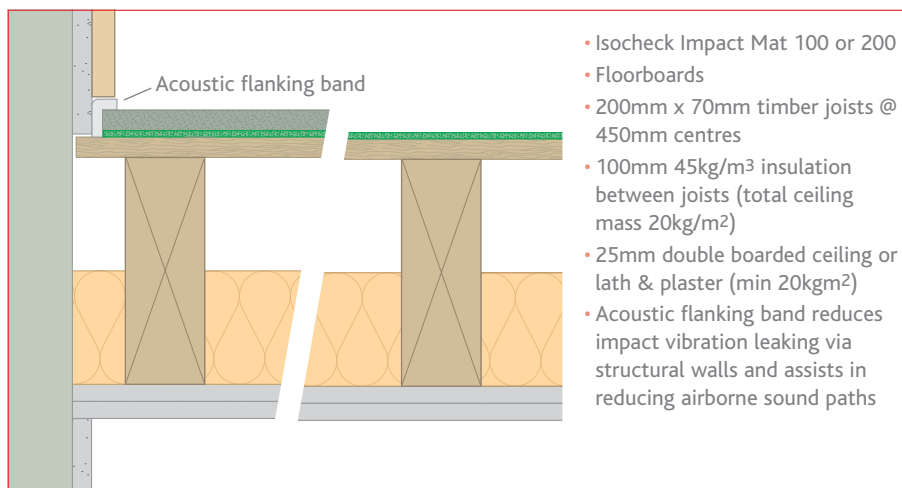

Every effort has been taken in the preparation of this sheet to ensure the accuracy of representations contained herein. Recommendations as to the use of materials, construction details and methods of installation are given in good faith and relate to typical situations. However, every site has different characteristics and reliance should not be placed upon the foregoing recommendations. Advice can be given as to specific applications.

### DESCRIPTION

Isocheck Impact Mat systems are designed to reduce impact sound transmission through timber floors and staircases.

Isocheck Impact Mat consists of 5.5mm and 9mm layers respectively of 'Isolate M'. When installed as part of a complete party floor construction it enables a timber floor to meet the sound transmission standards of ADE 2003 (amended 2004).

### SPECIFICATION

The acoustic floor shall be:

- **Isocheck Impact Mat**, supplied by Isomass Ltd. St Johns Innovation Centre, Cowley Road, Cambridge, CB4 0WS and installed in accordance with manufacturer's instructions / recommendations.

### INSTALLATION

- Lay isocheck Impact Mat 100 or 200 over the entire level floor with all joints butted.
- Most T&G or interlocking laminate panel floor finishes can be laid directly onto isocheck Impact Mat 100 and isocheck Impact Mat 200. If in doubt please contact us with the floors specification.
- Finished timber floors should be isolated from the skirting using Isocheck Acoustic Flanking Band.
- Full installation instructions are available and must be used in conjunction when laying this floating floor system.

For advice on treatment of services and penetrations, consult our brochure or visit our website:

[www.isomass.co.uk](http://www.isomass.co.uk)

### TECHNICAL ENQUIRIES

Tel: **0845 838 33 99**

Fax: **0845 838 33 89**

Email: [info@isomass.co.uk](mailto:info@isomass.co.uk)