

The isocheck Re-Mat 3 and Re-Mat 5 systems

Impact improvement system for new build & conversion

CI/SfB (43) (Y) (P2)

August 2008

Rev 1.0

product data sheet

PRODUCT DATA

Roll size & thickness	Re-Mat 3	1m x 20m x 3mm
	Re-Mat 5	1m x 20m x 5mm
Colour		Black or beige
Density		390kg/m ³

PERFORMANCE

Laboratory performance achieved a **17dB** ΔL_w for Re-Mat 3 and **18dB** ΔL_w for Re-Mat 5.

DESCRIPTION

Isocheck Re-Mat systems are designed to reduce impact sound transmission through concrete floor decks and all types of floor finishes including ceramic tiles, stone, marble, vinyl, carpet and solid or laminate wood. A heated floor system can also be installed beneath Re-Mat 3 or Re-Mat 5.

Isocheck Re-Mat 3 consists of a 3mm layer of matting and Re-Mat 5 consists of a 5mm layer of matting - both constructed from waste rubber and cork mixed

with a polymer binder to form a resilient mat.

When installed as part of a complete party floor construction it enables a concrete floor to meet the sound transmission standards of ADE 2003 (amended 2004).

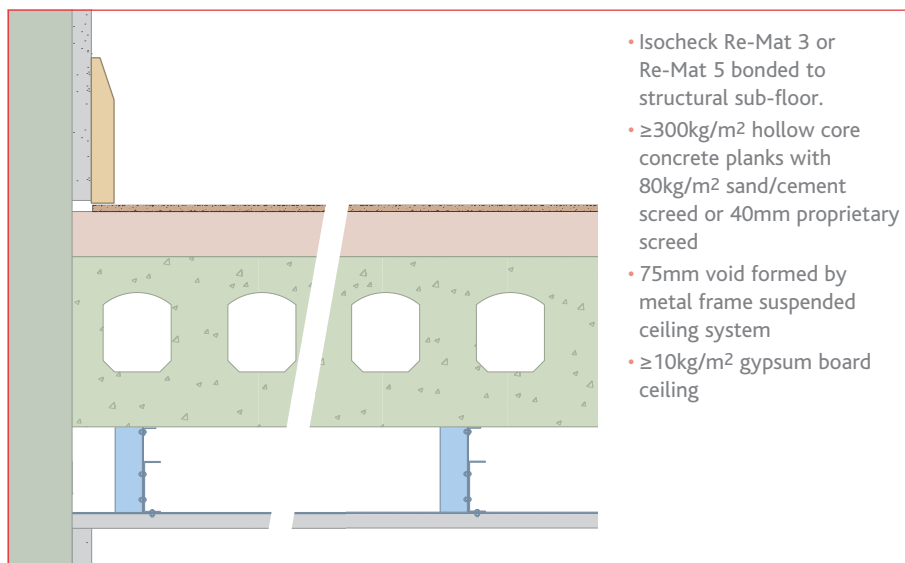

SPECIFICATION

The acoustic floor shall be:

- **Isocheck Re-Mat 3 or Isocheck Re-Mat 5**, supplied by Isomass Ltd. St Johns Innovation Centre, Cowley Road, Cambridge, CB4 OWS and installed in accordance with manufacturer's instructions / recommendations.

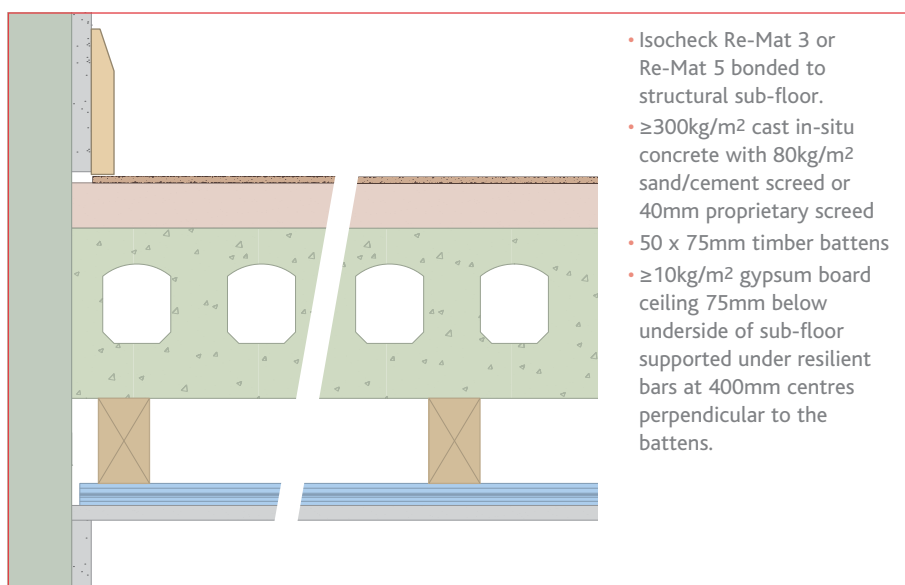

INSTALLATION

- Bond Isocheck Re-Mat 3 or Re-Mat 5 over the entire level screed with all joints butted.
- Full installation instructions are available and must be used in conjunction when laying this floor system.

For advice on treatment of services and penetrations, consult our brochure or visit our website:

www.isomass.co.uk

Every effort has been taken in the preparation of this sheet to ensure the accuracy of representations contained herein. Recommendations as to the use of materials, construction details and methods of installation are given in good faith and relate to typical situations. However, every site has different characteristics and reliance should not be placed upon the foregoing recommendations. Advice can be given as to specific applications.



Isomass Ltd. St Johns Innovation Centre, Cowley Road, Cambridge, Cambridgeshire CB4 OWS

TECHNICAL ENQUIRIES

Tel: **0845 838 33 99**

Fax: **0845 838 33 89**

Email: info@isomass.co.uk