

# The isocheck Shallow Batten system

CI/SfB

(43)

(Y)

(P2)

August 2008

Rev 2.0

## Suspended system for new build & conversion

### PRODUCT DATA

Overall batten size	1800mm x 45mm x 54mm*
Resilient layer thickness	8mm
Resilient layer	Isopoli cross-linked

\* alternative size battens are available to special order

### PERFORMANCE

Treated floor meets with the descriptive FFT3, typically within Robust Details E-FC-1 or E-FC-2. Two typical alternative constructions are shown.

### DESCRIPTION

Isocheck Shallow Batten system is designed to reduce sound transmission through a concrete structural sub-floor and consists of a layer of 8mm 'Isopoli' bonded to a softwood batten.

When installed as part of a complete party floor construction it enables a concrete floor to meet the sound transmission standards of ADE 2003 (amended 2004). Should the requirement be for a batten height other than that specified on this page please contact us for further technical advice and suitability.

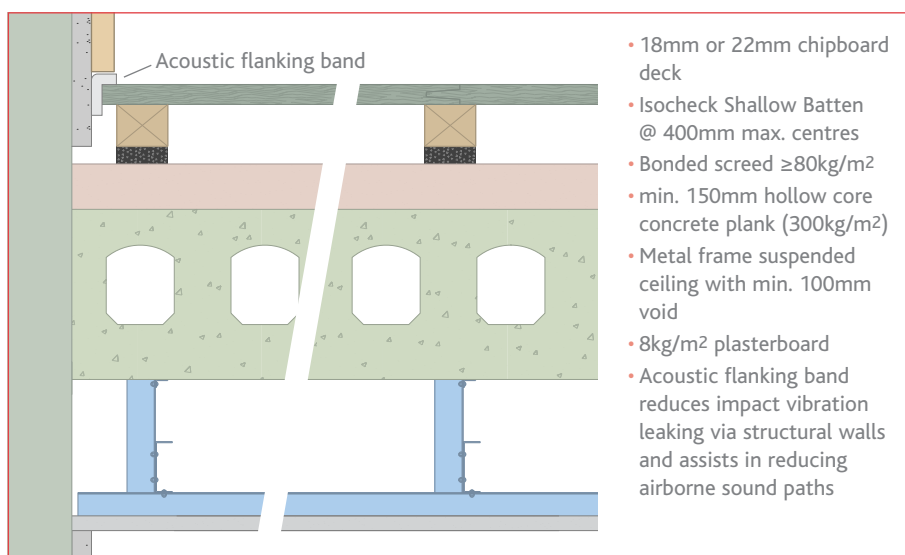
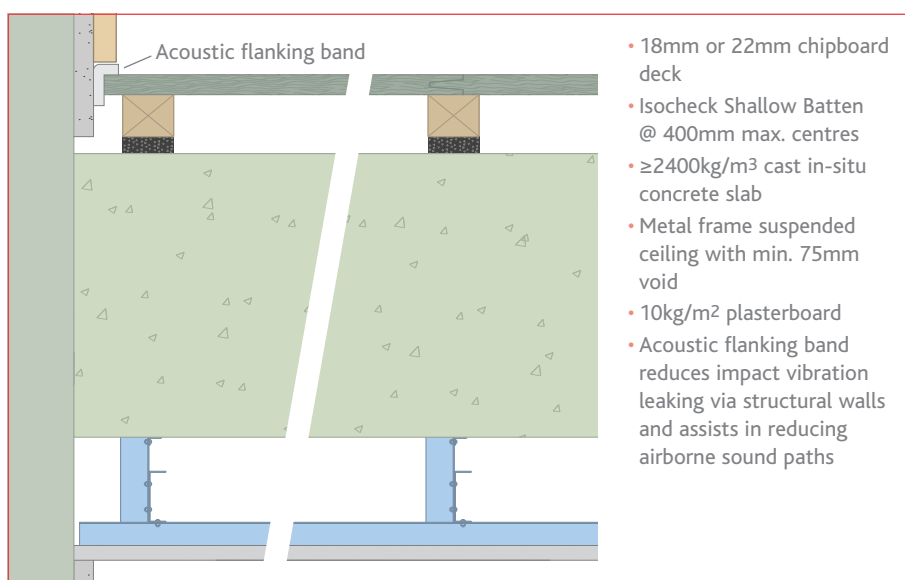

Every effort has been taken in the preparation of this sheet to ensure the accuracy of representations contained herein. Recommendations as to the use of materials, construction details and methods of installation are given in good faith and relate to typical situations. However, every site has different characteristics and reliance should not be placed upon the foregoing recommendations. Advice can be given as to specific applications.

### SPECIFICATION

The acoustic floor shall be:

- **Isocheck Shallow Batten**, by Isomass Ltd. St Johns Innovation Centre, Cowley Road, Cambridge, CB4 0WS and installed in accordance with manufacturer's instructions / recommendations.

### INSTALLATION

- Lay Isocheck Shallow Batten resilient layer side down, at 400mm max. centres for 18mm chipboard flooring or 500mm max. centres for 22mm chipboard flooring.
- Fix Isocheck Acoustic angled Flanking Band on the edges of the chipboard just before they are pushed against the perimeter walls to isolate the board from the wall.
- Apply Isocheck adhesive to all tongued and grooved panel joints.
- Install skirting and trim off excess Flanking Band.
- Full installation instructions are available and must be used in conjunction when laying this floating floor system.

For advice on treatment of services and penetrations, consult our brochure or visit our website:

[www.isomass.co.uk](http://www.isomass.co.uk)

### TECHNICAL ENQUIRIES

Tel: **0845 838 33 99**

Fax: **0845 838 33 89**

Email: [info@isomass.co.uk](mailto:info@isomass.co.uk)