

Uniclass L3272:P7114	EPIC F642:X725
CI/SFB (31.9)	Hn6

SUPAFIX INSULATED CAVITY CLOSER

DACATIE
BUILDINGSOLUTIONS

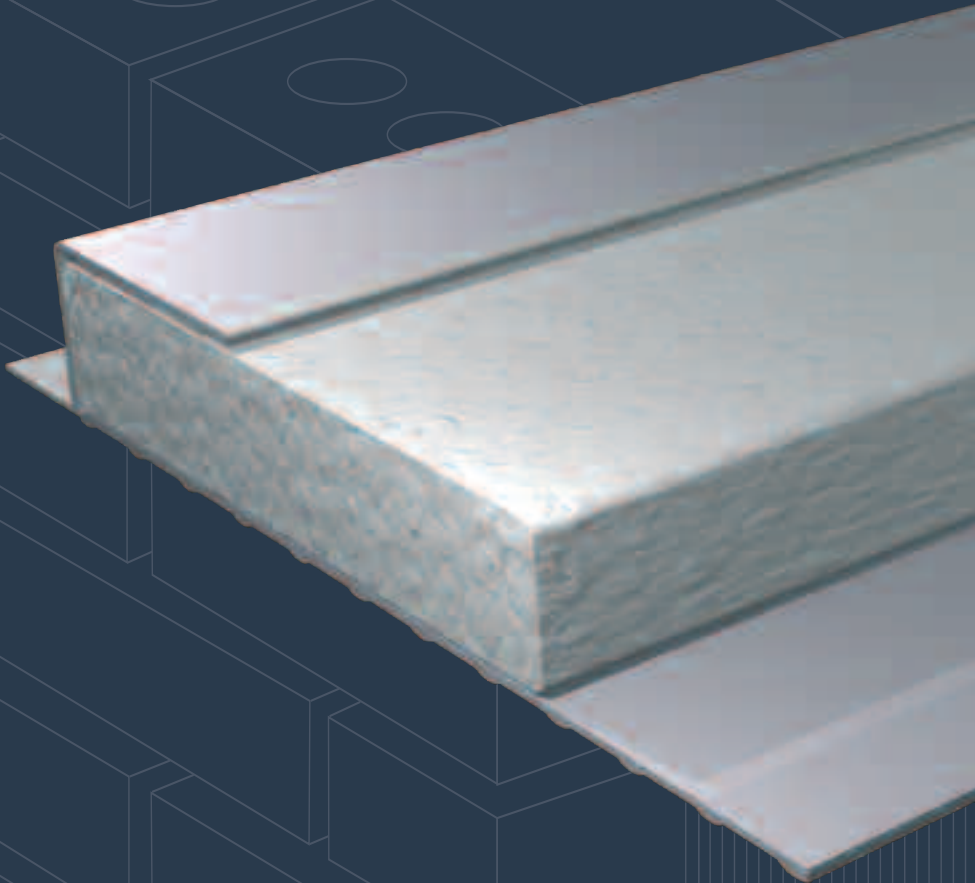

RECOMMENDED FOR CLOSING THE CAVITY AROUND WINDOW AND DOOR OPENINGS IN SECOND-FIX INSTALLATIONS WHEN A FRAME FORMER IS NOT REQUIRED.

AN ECONOMICAL WAY TO ACHIEVE BUILDING REGULATIONS COMPLIANCE

Supafix

Features

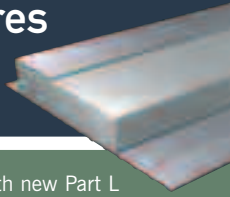

Complies with new Part L Building Regulations

Economical

Available in wide range of widths for standard and check reveal cavities

Reduces risk of condensation, mould & moisture migration across the cavity

Overcomes cavity width variations

Weather resistant

Easy to install

No ties required - simply nail to blocks

Can be used on timber frame construction

Specifications

Profile

White non water-absorbing PVCu

Insulation

EPS insulation, HCFC & HFC free

Lengths

2.1 & 3.0 metres

Cavity widths

Standard widths 50mm, 65mm, 75mm, 85mm, 90mm & 100mm. Variations of the above cavity widths between 50 - 100mm available on request

Minimal thermal resistance path

0.45m²/KW

Specification Statement

Close cavity openings at window jambs/sills and external doors utilising Dacatie Supafix. Installation should be completed in accordance with the manufacturers instructions

Regulations

Approved Document Part L revised 2002

With 30mm window frame set-back, complies with thermal requirements. BBA approved for moderate and sheltered conditions

Manufactured to ISO9001

Order codes

Standard: SF/cavity width in mm

Check Reveal: CSF/cavity width in mm

Supafix

INSULATED CAVITY CLOSER

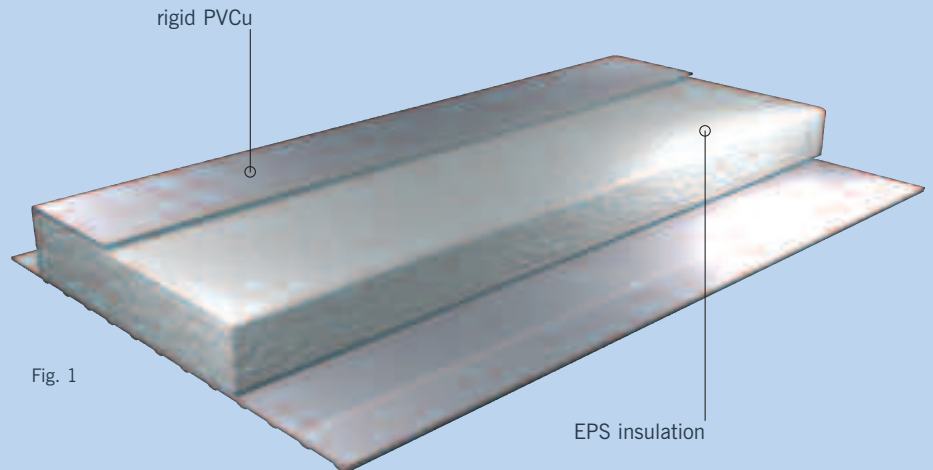
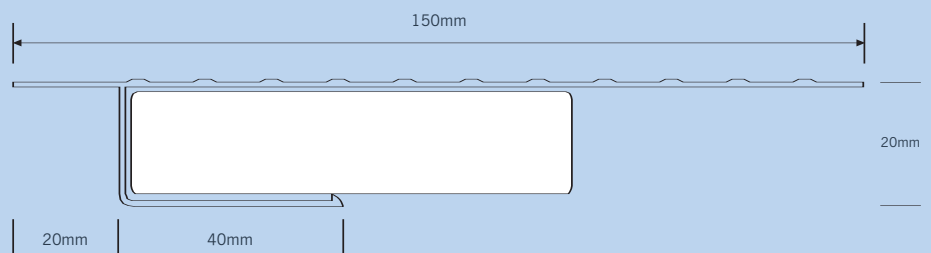

Fig. 1

Supafix (SF) insulated cavity closers are the economical way to achieve building regulations compliance, when closing cavities around window and door openings. SF provides a highly versatile solution in second fix installation when a frame former is not required.

The rigid PVCu profile encloses a core of CFC-free EPS insulation which forms a continuous insulated cavity closer preventing cold bridging. Supafix can be used with all types of door and window openings. Supafix cavity closers overcome the traditional difficulties of closing cavities at wall openings by providing a simple and efficient solution to thermal bridging. Supafix is primarily designed for second fix applications and can be simply cut to length and push fitted into the cavity after the window or door opening has been made thus eliminating the need for cut blocks, bricks or special reveal blocks. Supafix is available in a range of sizes to fit cavity widths from 50mm - 100mm, with sufficient design flexibility to tolerate rogue cavity widths, thus reducing time and cost on site.



RECOMMENDED FOR CLOSING THE CAVITY AROUND WINDOW AND DOOR OPENINGS IN SECOND-FIX INSTALLATIONS WHEN A FRAME FORMER IS NOT REQUIRED.

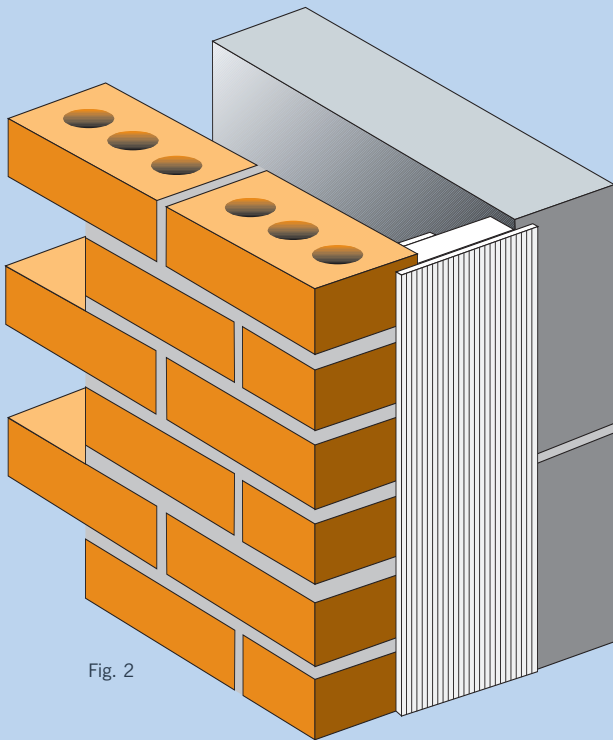

Fig. 2

APPLICATION

SF profile is suitable for use with all window and door frame materials, including timber, PVCu and aluminium. SF is cut to the height or width of the cavity opening and then push fitted into the cavity (fig.2). Slight cavity width variations can be overcome by applying small pressure. For this purpose a margin of insulating material projects from the PVCu encasement to allow a firm friction fit. In cases of extreme cavity width variation, this projecting insulation can be trimmed on site with a knife to allow insertion into the cavity.

THE PROBLEM OF COLD BRIDGING (Fig. 3)

The problems of cold bridging are recognised in the new Part L Building Regulation revised 2002. Part L recommends that an insulated cavity closer be used to overcome thermal loss that occurs in unprotected cavities and reveals. Thermal loss can result in problems of condensation, staining and mould growth at the reveals of these openings. Prolonged exposure to such factors will lead to a deterioration of the internal plaster and paint work. The use of SF will help to prevent the occurrence of such factors.

PART L REVISED 2002

SF will exceed the minimum requirement of $0.45 \text{ m}^2 \text{ K/W}$ for thermal resistance. When for example the window is set back at 30mm, the thermal resistance will in fact exceed $0.75 \text{ m}^2 \text{ K/W}$ (as indicated in the Robust Detail for walls). The minimum u value requirement of 0.35 W/m^2 will be achieved if all products are fitted to manufacturers recommendations and thermally efficient products are used within the construction.

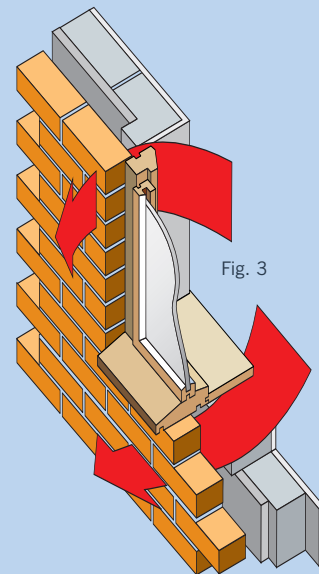

Fig. 3

Fig. 3 Identifies the heat loss from a building which is the cause of cold bridging.

SUPAFIX

A RANGE OF PERFORMANCE
YOU CAN TRUST

D3000

INSULATED CAVITY CLOSER

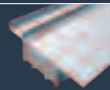

D2000

INSULATED CAVITY CLOSER

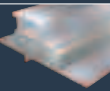

D2000 FIRE RATED

INSULATED CAVITY CLOSER



Frame Formers

INSULATED CAVITY CLOSER



TF8i

INSULATED CAVITY CLOSER

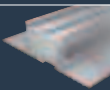

Supafix FIRE RATED

INSULATED CAVITY CLOSER

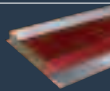

Supafix

INSULATED CAVITY CLOSER

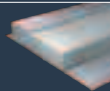

DPC

INSULATED DPC

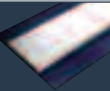

Weepholes

MOISTURE RELEASE FROM CAVITIES



Supafix Multicloser

MULTI WIDTH INSULATED CAVITY CLOSER



Dacatie D2000, TF8i, and Supafix are
BBA Approved.



www.dacatie.co.uk

DACATIETM
BUILDINGSOLUTIONS

SALES & TECHNICAL SUPPORT

0161 622 2020

f: 0161 622 2022 e: sales@dacatie.co.uk

QUANTUM PROFILE SYSTEMS LTD.

SALMON FIELDS ROYTON OLDHAM LANCASHIRE OL2 6JG
t: 0161 622 2020 f: 0161 622 2022 e: info@dacatie.co.uk

DACATIE is a registered trade mark of Quantum Profile Systems Limited.