

TF1000/TF2000

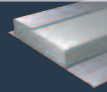

A RANGE OF PRODUCTS YOU CAN TRUST

**Supafix**  
INSULATED CAVITY CLOSER



**Supafix Multicloser**  
MULTI WIDTH INSULATED CAVITY CLOSER



**TF1000/2000**  
INSULATED CAVITY CLOSER



**D2000**  
INSULATED CAVITY CLOSER

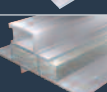

**D3000**  
INSULATED CAVITY CLOSER

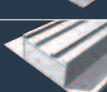

**Frame Formers**  
INSULATED CAVITY CLOSER

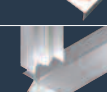

**D2000 FIRE RATED**  
INSULATED CAVITY CLOSER

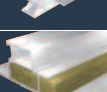

**Supafix FIRE RATED**  
INSULATED CAVITY CLOSER



**DPC**  
INSULATED DPC



**Accessories**  
WEEPHOLES & FIXING TIES

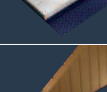

Dacatie D2000, TF1000/TF2000 and Supafix are BBA Approved.

www.dacatie.co.uk

SALES & TECHNICAL SUPPORT  
0161 622 2020  
f: 0161 622 2022 e: sales@dacatie.co.uk

QUANTUM PROFILE SYSTEMS LTD.  
SALMON FIELDS ROYTON OLDHAM LANCASHIRE OL2 6JG  
t: 0161 622 2020 f: 0161 622 2022 e: info@dacatie.co.uk

DACATIE is a registered trade mark of Quantum Profile Systems Limited.

Uniclass L3272:P7114	EPIC F642:X725
CI/SIB (31.9)	Hn6
June 2006	

## TF1000/TF2000 INSULATED CAVITY CLOSERS



Now with extruded polystyrene (XPS) giving improved thermal conductivity

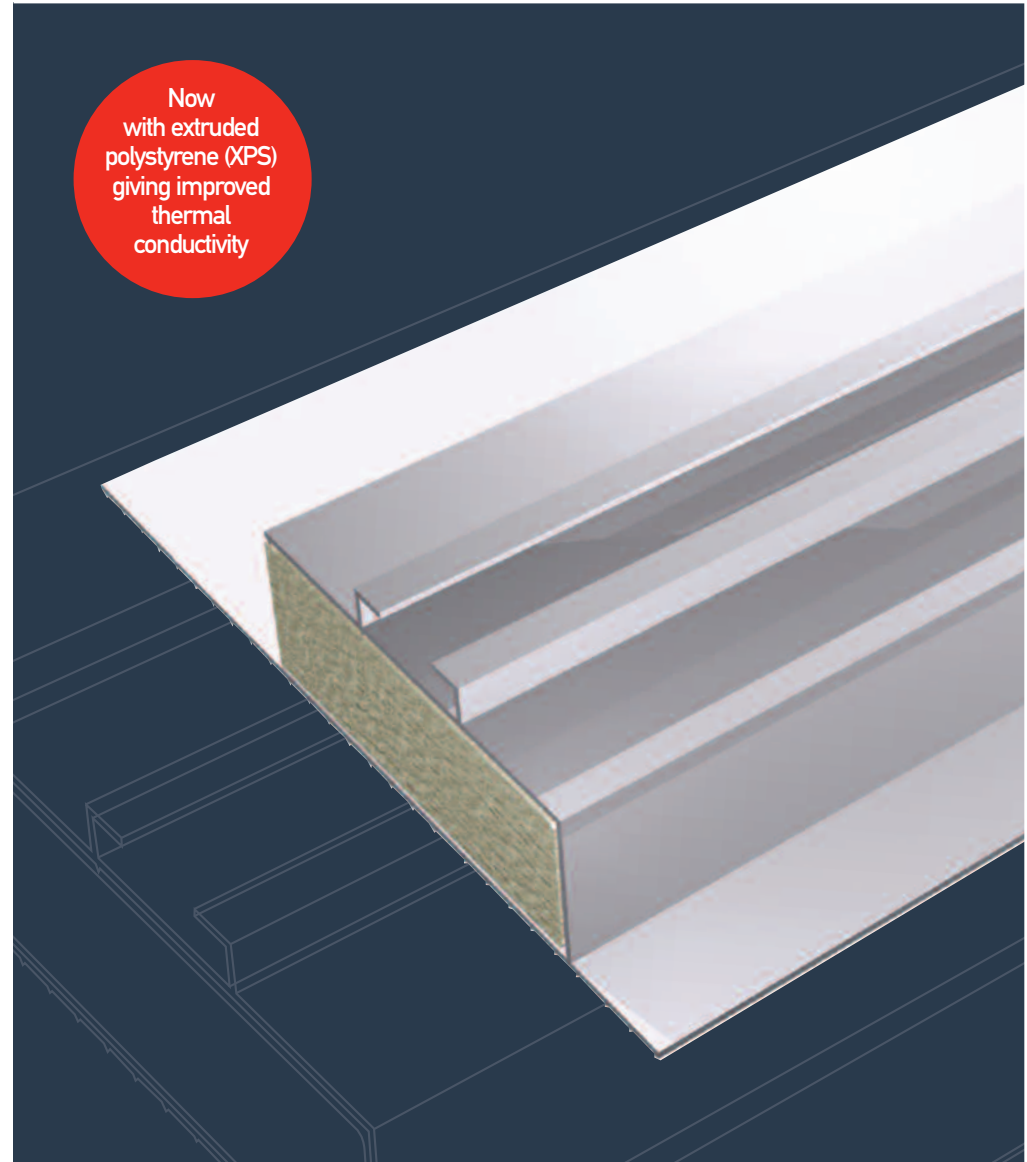

- First fix versatility
- Cavity range 50 - 160mm



THE BUILDERS CHOICE TO ACHIEVE BUILDING REGULATIONS COMPLIANCE

# TF1000/TF2000

## Features

- Rigid PVCu profile
- XPS insulation achieves lower thermal conductivity
- Complies with new Part L Building Regulations based on current information
- Reduces risk of condensation, mould & moisture migration across the cavity
- One piece profile closes cavities 50 - 160mm
- Ideal for first or second fix

## Specifications

### Profile

White non water-absorbing PVCu

### Insulation

Extruded Polystyrene (XPS), HCFC & CFC free

### Lengths

2.1 & 3.0 metres

### Cavity widths

**TF1000**  
Standard widths 50mm, 65mm, 75mm, 85mm, 90mm & 100mm

**TF2000**  
Standard widths 110mm, 125mm & 150mm  
Variations of the above cavity widths between 50 - 160mm available on request

**Minimal thermal resistance path**  
0.45m<sup>2</sup>K/W

**Thermal conductivity**  
0.027 W/mk

### Specification Statement

Close cavity openings at window jambs/sills and external doors utilising Dacatie TF1000/TF2000. Installation should be completed in accordance with the manufacturers instructions

## Regulations

Approved Document Part L revised 2002 and 2006

Complies with Robust Detail and BR262, providing severe weather rating at 30mm set back

Manufactured to ISO9001

## Order codes

**Standard:**  
TF1 + cavity width (50-100mm)  
TF2 + cavity width (110-160mm)

**Check reveal:**  
CTF1 + cavity width (50-100mm)  
CTF2 + cavity width (110-160mm)

**Fixing Ties:** DT4

# TF1000/TF2000

INSULATED CAVITY CLOSERS

Now with extruded polystyrene (XPS) giving improved thermal conductivity

TF1000

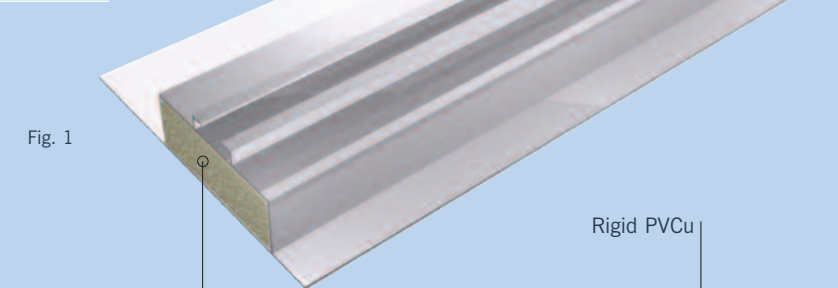

TF2000

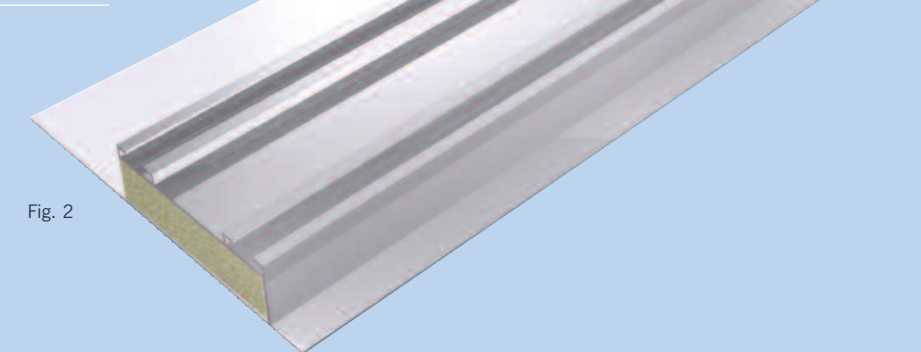

TF1000 & TF2000 fully insulated cavity closers are an ideal choice for builders and specifiers for the closing of cavities around window and door openings. Complies with the new Part L building regulations and can be used for first or second fix installation of doors and windows.

TF1000 & TF2000 has a rigid PVCu profile enclosing a core of CFC - free insulation that forms a continuous insulated cavity closer around door and window openings. This prevents cold bridging, damp penetration, air infiltration and condensation. The TF range can be used on all reveals or cavities and is suited to all types of windows and doors. The TF range is available in sizes to fit cavity widths from 50mm - 160mm.

RECOMMENDED FOR CLOSING THE CAVITY AROUND WINDOW AND DOOR OPENINGS IN FIRST AND SECOND-FIX INSTALLATIONS WHEN A FRAME FORMER IS NOT REQUIRED.

**DACATIE**  
BUILDINGSOLUTIONS

TF1000

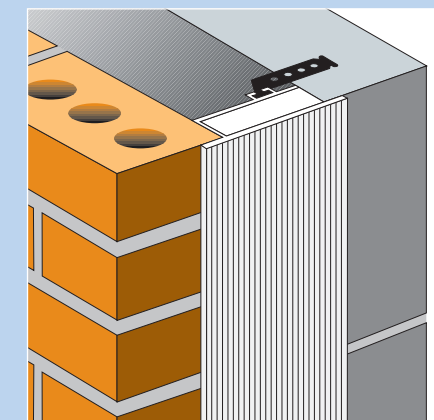

Fig. 3

TF2000

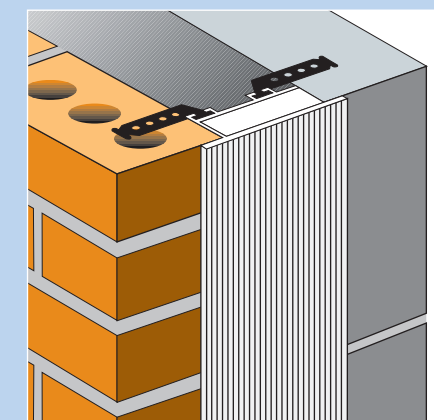

Fig. 4

### APPLICATION

TF1000 & TF2000 is suitable for use with all window and door frame materials, including timber, PVCu and aluminium. Also available for use in check reveal situations (CTF1000/2000 see figs 7 & 8 below).

### First Fix

First fix applications may be achieved by fixing the closer to a timber former or window and incorporating into the brickwork as it is constructed.

First fix cavity closer application requires DT4 fixing ties every 225mm.

### Second Fix and Retro Fix

Second fix applications are possible by cutting the closer to length, push fitting into the cavity and nailing to the brick or block work.

### STANDARD/FLUSH

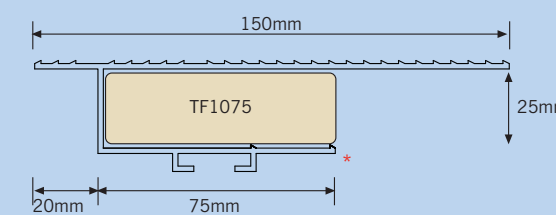

Fig. 5

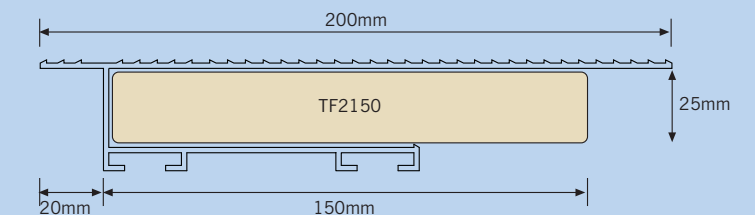

Fig. 6

### CHECK REVEAL

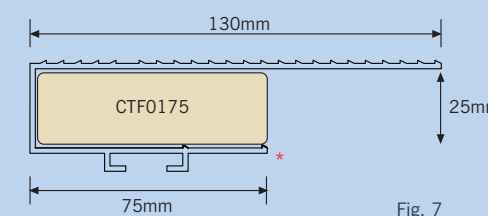

Fig. 7

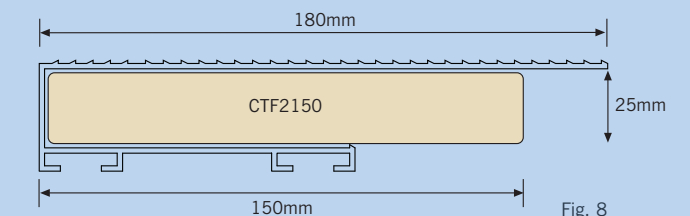

Fig. 8

\* Flange extension removed for 50mm