

# TORCHGOLD TANKING MEMBRANE



## INTRODUCTION

Torch Gold Tanking Membrane is a waterproofing membrane used for heavy duty tanking of concrete structures below ground. It is applied by the torch-on method and provides protection from ingress of water and water-borne chloride and sulphate ions which attack both concrete and steel reinforcements. Tanking is a critical area of construction where failure can result in major disruption in the use of the building and expensive remedial work. The high performance properties of Torch Gold Tanking Membranes have been designed to meet the tanking requirements of the Specifier and Contractor.

## DESCRIPTION

Torch Gold Tanking Membranes consist of a tough 250gsm polyester carrier coated with a high percentage of SBS (Styrene Butadiene Styrene) rubber modified bitumen to a total thickness of 4mm. The upper surface is finished with fine sand and the lower side has a sacrificial polyethylene film which melts during the torching operation.

## PERFORMANCE BENEFITS

- Ease of application - Torch Gold Tanking Membrane is torch applied and forms a strong bond to prepared surfaces and to itself when adjacent sheets are overlapped
- Resists substructure movement - the flexibility of Torch Gold Tanking Membrane is due to the high percentage of SBS rubber modified bitumen. This is retained throughout the lifetime of the structure ensuring a reliable waterproof seal even when subjected to stress caused by minor movements of the substructure
- Resists damage - the strong polyester reinforcement provides excellent puncture resistance and is also rot proof
- Chemically resistant
- Easily repaired - in the unlikely event of puncturing, damaged areas can easily be repaired by patching with another layer of Torch Gold Tanking Membrane

## WORKABILITY

Marley Waterproofing's Elastomeric Roofing Membranes remain flexible at temperatures below -20°C and have a modified coating with a softening point of 120°C. The products may be bent around a 30mm mandrel without rupture and will perform satisfactorily in all temperatures normally experienced within the UK.

## MANUFACTURE

Torch Gold Tanking Membranes are produced on the Company's purpose-built plant at Aylesham in Kent under a closely controlled system which conforms to the requirements of ISO 9001. Each roll is wrapped clearly identifying the product name, product code, batch code, roll width and length and the manufacturer's name and address.

## CONSTRUCTION

### Storage

Rolls of Torch Tanking Membrane must be stored on end on a flat surface, kept undercover and protected from mechanical damage in accordance with good site materials management.

### Installation

Torch Gold Tanking Membrane must be installed generally in accordance with the requirements of BS 8102: 1990.

The membrane must be fully bonded to the prepared substrate by using the torch-on application method. Both end and side laps should be a minimum of 100mm and the work should be set out with staggered end laps. Ensure that a constant flow of bitumen is maintained across the whole width of the roll and that a bead of bitumen is extruded from each edge which demonstrates that a good seal has been obtained. On vertical areas, the membrane should be cut to the appropriate length, bonded to the horizontally applied membrane and torch applied upwards.

### Preparation of Surfaces

All surfaces to which Torch Gold Tanking Membranes are to be applied should have a smooth finish and should be free from cavities, projections and loose mortar deposits. Damaged surfaces can be made good with a sand/cement mortar mix.

Surfaces must be frost free, dry and clear of contamination.

### Priming

All surfaces must be primed with Marley Waterproofing's Universal DPM/Tanking Primer (approximate coverage 3m<sup>2</sup> per litre) and left to dry thoroughly. Drying time will be dependent on weather conditions. On extremely porous surfaces, two coats of primer may be necessary.

### Angles and Corners

Angle strips should be cut from the Torch Gold Tanking Membrane and torch applied to reinforce all angles and corners before installation of the main sheet. All internal corners should be provided with 50 x 50mm angle fillets and external corners should be chamfered to facilitate full bonding.

### Membrane Protection

Loading of both vertical and horizontal tanking should be applied immediately after installation of the membrane.

**Note: A detailed inspection for damage and faults should be carried out before the membrane is permanently covered.**

## PRICING

Prices are available from our Roofing Distributors, details of which are available from our Customer Services Department

## ORDERING

When ordering, reference should be made to the product code number in order to avoid mistakes. Product codes can be found under the section 'Nominal Dimensions and Weights' of this data sheet.

## TECHNICAL SUPPORT

For further information, please contact our Technical Department on 01304 843 344



Due to the policy of continuous development, Marley Waterproofing reserves the right to change specifications without prior notice.

## NOMINAL DIMENSIONS AND WEIGHTS

Product Code	Roll Size	Roll Weight	Weight per kg/m <sup>2</sup>	Thickness	Minimum Overlaps
343608	8 x 1m	34kg	4.2kg	4mm	Side: 100mm End: 100mm

## TYPICAL TEST VALUES

Tensile Strength (N/50mm) (Test Method BS 747 App B3)	Longitudinal	720
	Transverse	620
Elongation at Break (%) (Test Method BS 747 App B3)	Longitudinal	30
	Transverse	50
Resistance to Tear (N) (Test Method BS 747 App C3)	Longitudinal	350
	Transverse	350
Puncture Resistance (BS 747 App C5)		>25kg
Mullen Burst Strength (kN/m <sup>2</sup> ) (Test Method BS 3137)		2400

## BITUMEN UNIVERSAL DPM/TANKING PRIMER

Part Code	646405 or 646425
Containers	5 or 25 litre cans
Flash Point	Above 32°C
Coverage	6-8m <sup>2</sup> /litre on Dense Concrete 3m <sup>2</sup> /litre on Porous Blockwork
Application Temperature	Not below 5°C
Drying time	Dependent on ambient conditions - typically 3-6 hours

## DESIGN DETAILS

### STARTER BAR DETAIL

**NOTE:**

All Marley Waterproofing products must be installed in accordance with the relevant Waterproofing literature, British Standards & Building Regulations.

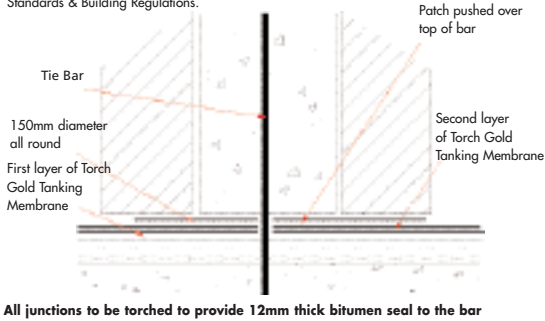

### SERVICE PIPE PENETRATION

**NOTE 1:** All Marley Waterproofing products must be installed in accordance with the relevant Marley Waterproofing literature, British Standards & Building Regulations.  
**NOTE 2:** Loading walls and floors are to be designed to withstand hydroelastic pressure refer to a Structural Engineer

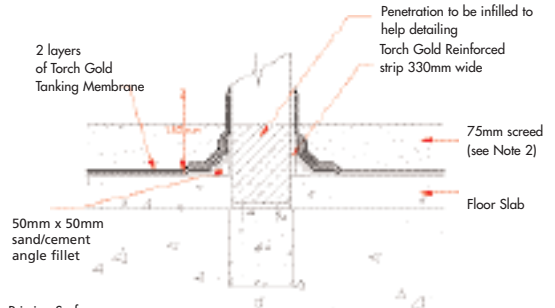

**Priming Surfaces:**

Prime all surfaces prior to the application of the membrane in accordance with the Marley Waterproofing method statement

### EXTERNAL TANKING

**NOTE:** All Marley Waterproofing products must be installed in accordance with the relevant Marley Waterproofing literature, British Standards & Building Regulations.

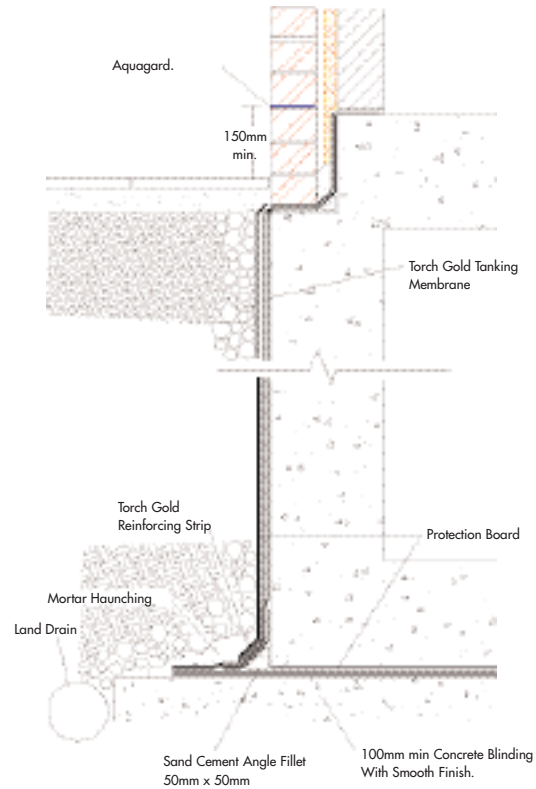

### INTERNAL TANKING

**NOTE:** All Marley Waterproofing products must be installed in accordance with the relevant Marley Waterproofing literature, British Standards & Building Regulations.

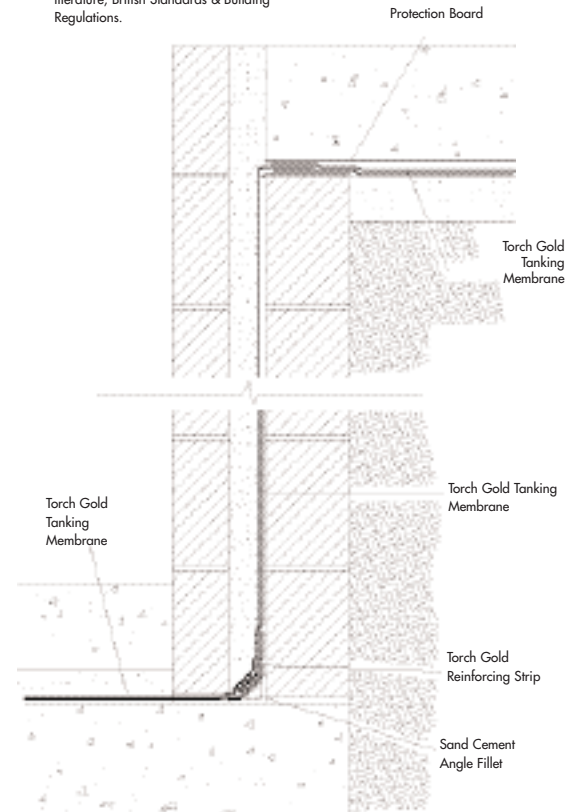

Marley Waterproofing, Covert Road, Aylesham Industrial Estate, Aylesham, Kent CT3 3EQ  
 tel: 01304 843300 fax: 01304 843500 e-mail: info@marleywaterproofing.com www.marleywaterproofing.com