

Bituthene® 2000

Pre-formed self-adhesive rubber bitumen/HDPE damp-proof membrane.

Advantages

- Flexible - accommodates shrinkage movement.
- Cold applied - no heating, simple, low labour cost.
- Self-adhesive - full continuity at overlaps.
- Factory controlled thickness - no variation by site labour.
- Rubber/bitumen - flexibility and resistance to most dilute acids and alkalis.
- Preformed film surface - immediate access for same day screeding.
- Specification compliance - CP102: 1973, Section 3; Damp-proofing of walls and floors.
- Programme saving - can be screeded immediately.

Applications

Bituthene® 2000 is a combination of a high density polyethylene film and a self-adhesive rubber/bitumen compound. It is supplied in rolls 1mm thick overall, 1m wide and 25 m long (25 sq metres) and is unrolled sticky side down on to concrete. Damp-proof joints are made by overlapping 25 mm and firmly rolling surfaces. Applied to top of a concrete slab, Bituthene 2000 will provide a moisture/vapour proof barrier to comply with Building Regulations 1991 Clause C2.

Being factory made, thickness of membrane is constant throughout and is not subjected to variations by site labour such as occurs with brush applied materials. Bituthene 2000 is flexible and well capable of bridging shrinkage cracks in the concrete.

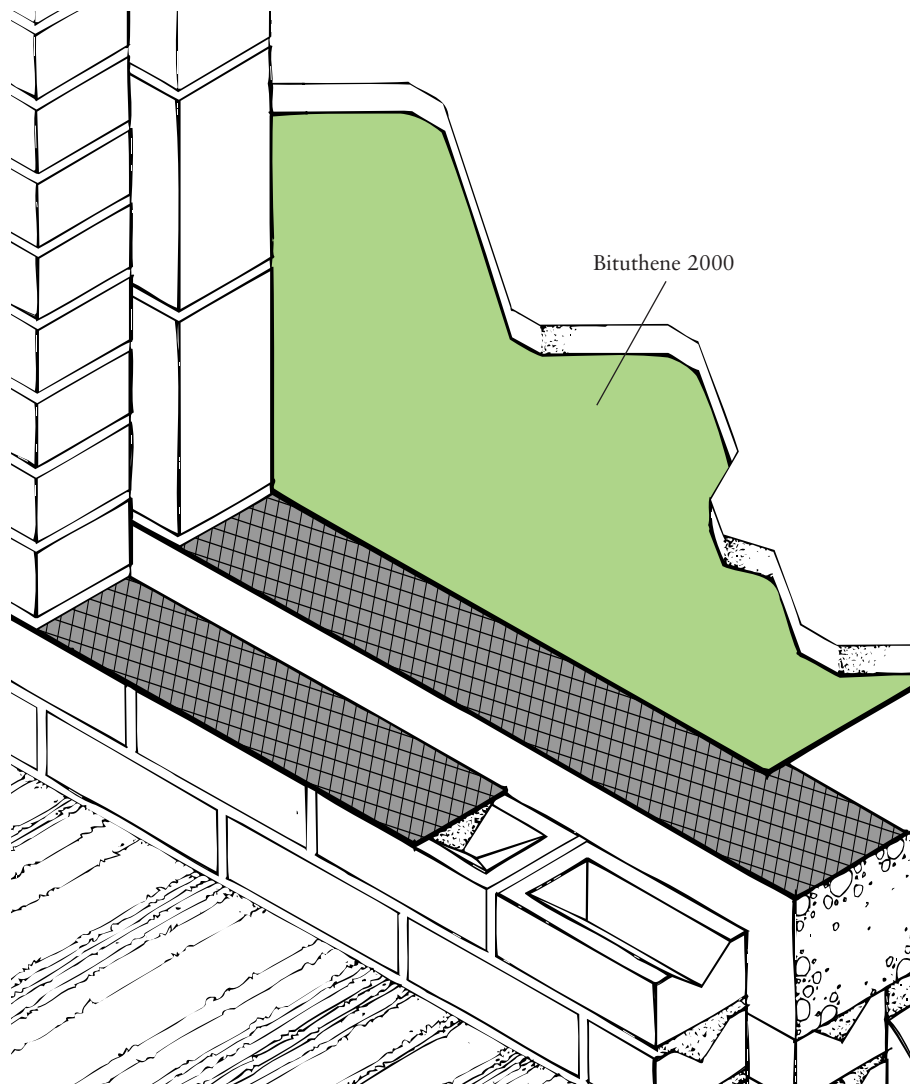

Supply

Bituthene® 2000	1 m x 25 m roll (25 sq m)	Weight 30 kg gross
Palletisation	15 rolls per pallet	
Storage	Store upright in dry conditions below +30°C	
Ancillary Materials		
Primer B1	5 and 25 litre drums	
Coverage	10-12 sq metre per litre depending on method of application, surface texture, porosity and ambient temperature	
Bituthene® LM	5.7 litre packs	
Lap Roller	Unit	

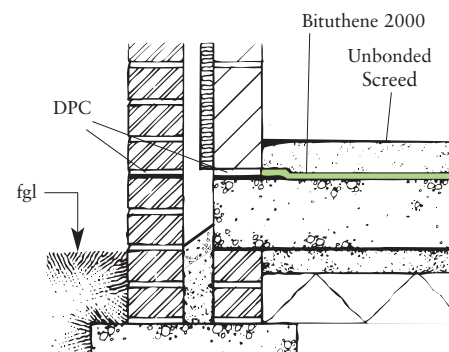

Equipment by Others

Soft brush, Stanley knife; brush or roller for priming. Stiff broom and airline for cleaning surface.

Performance

	Typical Value	Test Method
Tear Resistance	Long 91.6N Trans 89.6N	MOAT 27:5.4.1
Peel Strength	105.4N	MOAT 27:5.1.3
Tensile Strength of joints	130.6N	MOAT 27:5.2.2
Moisture Vapour Permeability	0.39 g/m ² /24 hours	BS 3177: 1959 (75% RH/25°C)

Membrane, read the product label and Material Safety Data Sheet (MSDS) before use. Users must comply with all risk and safety phrases. MSDS's can be obtained from Grace Construction Products or from our web site at www.graceconstruction.com.

NBS Specification Clause

Refer to Clause J40 190.

Specification Compliance

Bituthene® 2000 complies with Building Regulations (England and Wales) 1991 (amended 1994) clause C4. Building Regulations (Northern Ireland) 1994 (amended 1995) clause B2. Building Standard (Scotland) Regulations 1990, Regulation B2.1, G2.6.

Installation

Minimum ambient application temperature 4°C. Ensure that all surfaces are clean, dry and free from ice/frost.

Concrete base slab shall be surface dry, free from standing water, and laid to a regular surface free from sharp protrusions and hollows. Vertical faces shall be smooth, regular, dry and free from nails and primed with one coat of Primer B1 applied by roller or brush, at a rate depending on the porosity of the surface and allowed to dry before the application of the Bituthene 2000. Brickwork must be flush pointed or rendered to provide a smooth surface.

Bituthene 2000 shall be laid by peeling back the protective release paper and applying the adhesive face on to the prepared surface. The material should be brushed on to the surface to exclude air. Adjacent rolls are aligned and overlapped

25mm minimum at side and ends and well rolled with a firm pressure using a lap roller to ensure completed adhesion and continuity between the layers. Continuity on curved or irregular surfaces and at pipe entries and terminations may be provided with Bituthene LM two component chemically curing liquid applied waterproof membrane.

Following the application care should be taken to prevent damage by following trades. Damaged areas can be repaired by patching with an oversize patch applied to a clean dry surface and firmly rolled.

Health And Safety

There is no legal requirement for a Material Safety Data Sheet for Bituthene 2000, or Lap Roller. For health and safety questions on these products please contact Grace Construction Products Limited. For Primer B1 and Bituthene Liquid

Details shown are typical illustrations only and not working drawings. For assistance with working drawings and additional technical advice please contact Grace Technical Services

 Visit our web site at www.graceconstruction.com

Grace Construction Products Ltd, Ajax Avenue, Slough, Berkshire SL1 4BH United Kingdom Tel +44 (0)1753 692929 Fax +44 (0)1753 691623

Adcor, Aerofil, BETEC, Bituthene, Hydproduct, Insupak, Korkpak, Paraflex, Paraseal, Preprufe, Procor, Servised, Servidek, Servigard, Servijoint, Servimastic, Servipak, Servirufe, Serviseal, Servistrip, Servitite, Vertigard and Vertiseal are registered trademarks of W R Grace & Co.-Conn.
Adprufe, Armourtape, Bitushield, Bitustik, Bitutape, Hydropaste, Pak Adhesive, PVC Edgetie, Serviband, Serviflex, Servitape, Slipstrip, and Solarshield are trademarks of W R Grace & Co.-Conn.

The information given is based on data and knowledge considered to be true and accurate and is offered for the user's consideration, investigation and verification. Since the conditions of use are beyond our control we do not warrant the results to be obtained. Please read all statements, recommendations or suggestions in conjunction with our conditions of sale including those limiting warranties and remedies which apply to all goods supplied by us. No statement, recommendation or suggestion is intended for any use which would violate or infringe statutory obligations or any rights belonging to a third party.

Copyright 2006. Grace Construction Products Limited.

Printed in England - 05.06- Ref. WM006B

GRACE
Construction Products